

GPS SURVEY MARK DESCRIPTION

GIS MAPPING BY:
 THE SIDWELL COMPANY
 WEST CHICAGO, ILLINOIS

THE OFFICE OF THE
 COUNTY ENGINEER
 DICKINSON COUNTY, IOWA

DESIGNATION 1013731 3 GPS NO. 8007 COUNTY JACKSON STATE IA
 LOCATED IN SECTION 31 TWP 101 N RANGE 37 W USGS QUAD MAP Lake Park
 THE STATION IS
 NORTHEASTERLY OF THE INTERSECTION BETWEEN 100TH STREET AND 130TH AVENUE.

MARK BERNTSEN MONUMENT WITH 2-1/2" ALUMINUM DISK ON ROD WITH 6" ACCESS COVER

MARK EXISTING VALUES AS PUBLISHED BY
 MARK SET VALUES ESTABLISHED BY Patrick Engineering Inc. DATE August, 2002

HORIZONTAL VALUES ORIGINATED ON ORDER "B" IOWA HIGH ACCURACY REFERENCE NETWORK (HARN) CONTROL ESTABLISHED BY THE NATIONAL GEODETIC SURVEY AND BASED ON THE NORTH AMERICAN DATUM OF 1983, 1996 ADJUSTMENT.

LATITUDE NORTH 43° 30' 01.857179"
 LONGITUDE WEST 95° 19' 44.332049"
 ELLIPSOID HEIGHT (meter) 425.398 * (Based on GEOID99 Model)

IOWA COORDINATE SYSTEM, NORTH ZONE
 CONVERGENCE ANGLE -1° 14' 22.5"
 SCALE FACTOR 0.999984

COORDINATES (US FEET)
 NORTHING (Y) 4015160.92 COORDINATES (METERS)
 EASTING (X) 4435960.02 NORTHING (Y) 1223823.496
 EASTING (X) 1352083.318

VERTICAL VALUES ORIGINATED ON VERTICAL CONTROL ESTABLISHED BY THE NATIONAL GEODETIC SURVEY AND/OR THE U.S. GEOLOGICAL SURVEY AND BASED ON THE NORTH AMERICAN VERTICAL DATUM OF 1988.

ELEVATION (US FEET) 1485.41 ELEVATION (METERS) 452.754

TIES
 NO.1-37.5'
 NO.2-6.5'
 NO.3-22.0'
 NO.4-

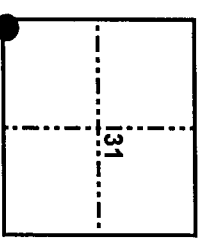
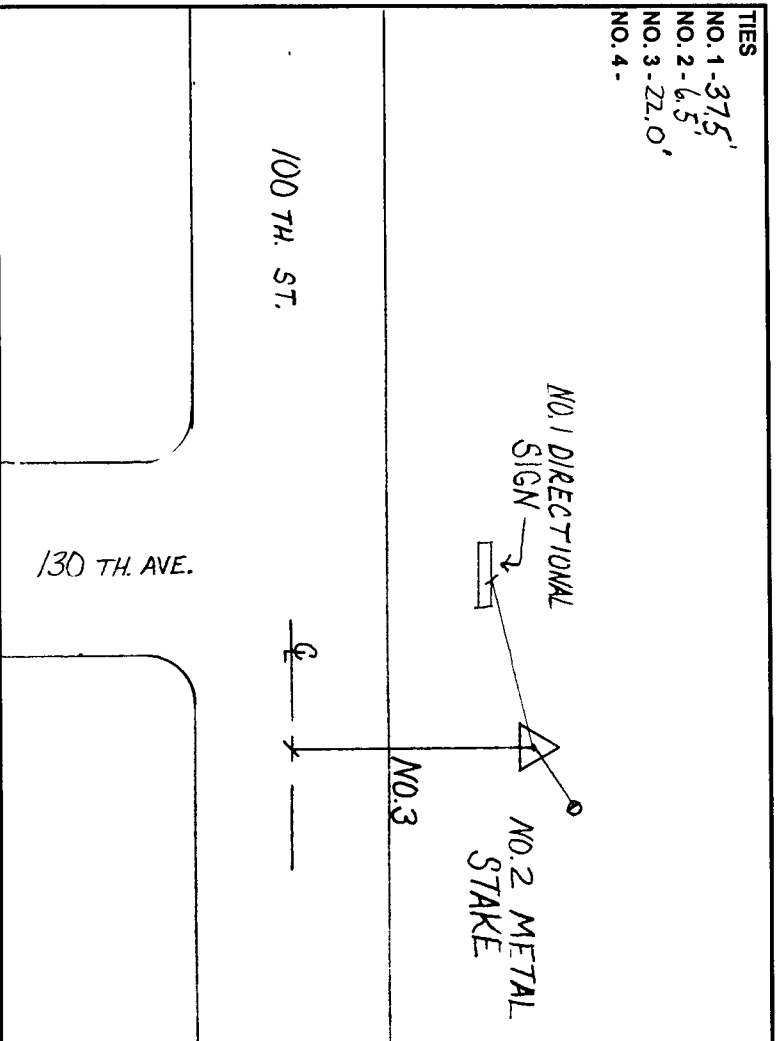

SECTION MAP

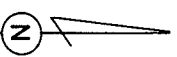

SKETCH BY CCS
 PATRICK 09-2002