

GPS SURVEY MARK DESCRIPTION

**GIS MAPPING BY:
THE SIDWELL COMPANY
WEST CHICAGO, ILLINOIS**

**THE OFFICE OF THE
COUNTY ENGINEER
DICKINSON COUNTY, IOWA**

DESIGNATION 1003833 2 **GPS NO.** 8009 **COUNTY** DICKINSON **STATE** IOWA
LOCATED IN SECTION 33 **TWP** 100 N **RANGE** 38 W **USGS QUAD MAP** LAKE PARK
TO REACH FROM _____
THE INTERSECTION OF HIGHWAY 9 AND 130TH AVENUE. HEAD WEST ON HIGHWAY 9 0.2 MILE TO THE STATION

MARK BERNTSEN MONUMENT WITH 2-1/2" ALUMINUM DISK ON ROD WITH 6" ACCESS COVER

MARK EXISTING VALUES AS PUBLISHED BY _____ **DATE** August, 2002
 MARK SET VALUES ESTABLISHED BY Patrick Engineering Inc

HORIZONTAL VALUES ORIGINATED ON ORDER "B" IOWA HIGH ACCURACY REFERENCE NETWORK (HARN) CONTROL ESTABLISHED BY THE NATIONAL GEODETIC SURVEY AND BASED ON THE NORTH AMERICAN DATUM OF 1983, 1996 ADJUSTMENT.

LATITUDE NORTH 43° 25' 50.993267"
LONGITUDE WEST 95° 19' 44.431428"
ELLIPSOID HEIGHT (meter) 419.816 * (Based on GEOID99 Model)

IOWA COORDINATE SYSTEM, NORTH ZONE	CONVERGENCE ANGLE	<u>-1° 14' 22.56"</u>
COORDINATES (US FEET)	SCALE FACTOR	<u>0.999968</u>
NORTHING (Y)	COORDINATES (METERS)	<u>1216082.963</u>
EASTING (X)	NORTHING (Y)	<u>1351913.593</u>
	EASTING (X)	

VERTICAL VALUES ORIGINATED ON VERTICAL CONTROL ESTABLISHED BY THE NATIONAL GEODETIC SURVEY AND/OR THE U.S. GEOLOGICAL SURVEY AND BASED ON THE NORTH AMERICAN VERTICAL DATUM OF 1988.

ELEVATION (US FEET) 1467.55 **ELEVATION (METERS)** 447.310

TIES
 NO. 1 - 26.5'
 NO. 2 - 10.0'
 NO. 3 - 3.6'
 NO. 4 - 117'

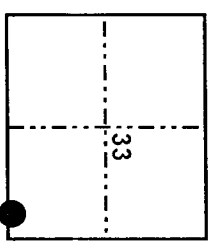
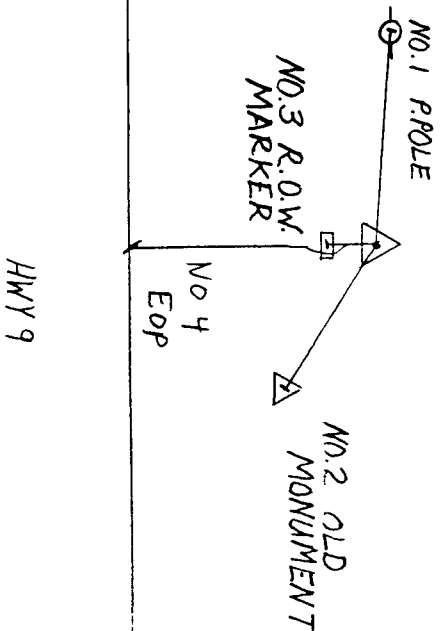

SECTION MAP

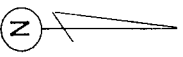

SKETCH BY PCS

PATRICK 09-2002