

**GPS SURVEY MARK DESCRIPTION**

GIS MAPPING BY:  
**THE SIDWELL COMPANY**  
 WEST CHICAGO, ILLINOIS

THE OFFICE OF THE  
 COUNTY ENGINEER  
 DICKINSON COUNTY, IOWA

DESIGNATION 983822 4 GPS NO. 8012 COUNTY DICKINSON STATE IOWA  
 LOCATED IN SECTION 22 TWP 98 N RANGE 38 W USGS QUAD MAP LAKE PARK SE  
 THE STATION IS \_\_\_\_\_  
 AT THE SOUTHEAST CORNER OF THE INTERSECTION BETWEEN 240TH STREET AND 130 (M27) AVENUE

MARK BERNTSEN MONUMENT WITH 2-1/2" ALUMINUM DISK ON ROD WITH 6" ACCESS COVER

MARK EXISTING  VALUES AS PUBLISHED BY \_\_\_\_\_ DATE August, 2002  
 MARK SET  VALUES ESTABLISHED BY Patrick Engineering Inc

HORIZONTAL VALUES ORIGINATED ON ORDER "B" IOWA HIGH ACCURACY REFERENCE NETWORK (HARN) CONTROL ESTABLISHED BY THE NATIONAL GEODETIC SURVEY AND BASED ON THE NORTH AMERICAN DATUM OF 1983, 1996 ADJUSTMENT.

LATITUDE NORTH 43° 17' 54.363594"  
 LONGITUDE WEST 95° 19' 42.397838"  
 ELLIPSOID HEIGHT (meter) 398 919 \* (Based on GEOID99 Model)

IOWA COORDINATE SYSTEM, NORTH ZONE  
 CONVERGENCE ANGLE -1° 14' 21 18"  
 SCALE FACTOR 0.999943  
 COORDINATES (METERS)  
 NORTHING (Y) 1201375 824  
 EASTING (X) 1351641 202

VERTICAL VALUES ORIGINATED ON VERTICAL CONTROL ESTABLISHED BY THE NATIONAL GEODETIC SURVEY AND/OR THE U.S. GEOLOGICAL SURVEY AND BASED ON THE NORTH AMERICAN VERTICAL DATUM OF 1988.

ELEVATION (US FEET) 1400 16 ELEVATION (METERS) 426 770

TIES  
 NO. 1 - 54.4'  
 NO. 2 - 123'  
 NO. 3 - 92.5'  
 NO. 4 - \_\_\_\_\_

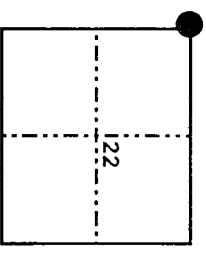
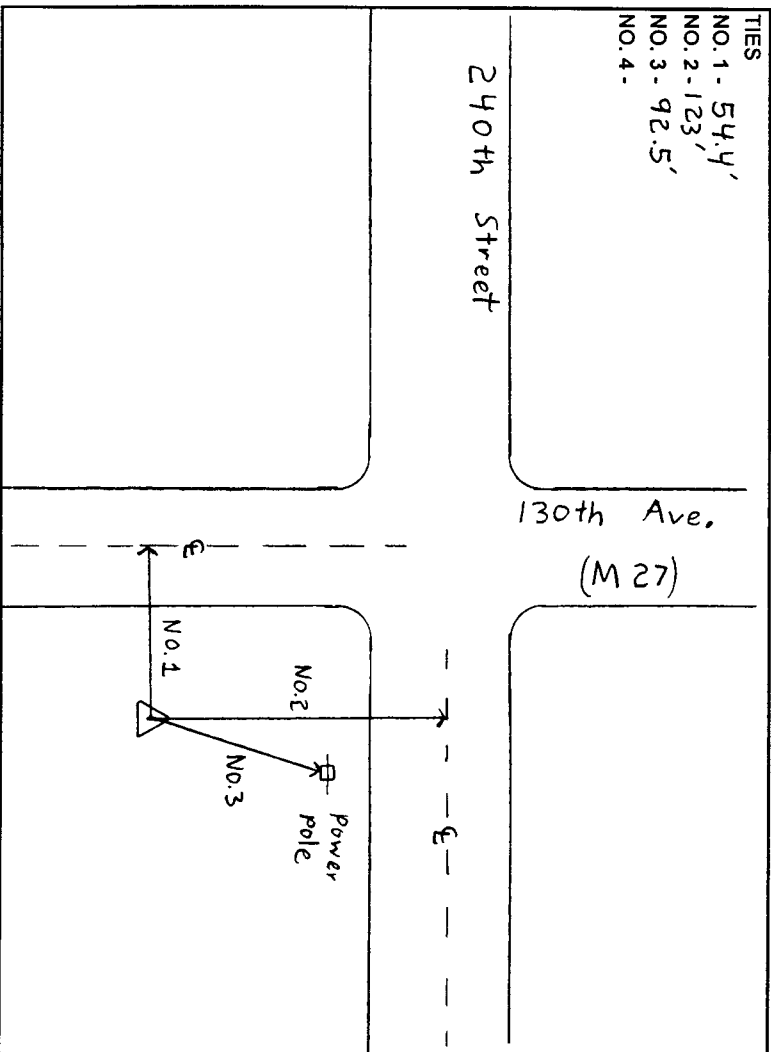

SECTION MAP



SKETCH BY SL  
 PATRICK 09-2002