

**GPS SURVEY MARK DESCRIPTION**

**GIS MAPPING BY:**  
**THE SIDWELL COMPANY**  
**WEST CHICAGO, ILLINOIS**

**THE OFFICE OF THE**  
**COUNTY ENGINEER**  
**DICKINSON COUNTY, IOWA**

**DESIGNATION** 983813 2 **GPS NO.** 8018 **COUNTY** DICKINSON **STATE** IOWA  
**LOCATED IN SECTION** 13 **TWP** 98 N **RANGE** 38 W **USGS QUAD MAP** LAKE PARK SE  
**THE STATION IS** \_\_\_\_\_  
**AT THE NORTHWEST CORNER OF THE INTERSECTION BETWEEN 240TH STREET AND 160TH AVENUE.**

**MARK** BERNTSEN MONUMENT WITH 2-1/2" ALUMINUM DISK ON ROD WITH 6" ACCESS COVER  
 MARK EXISTING  VALUES AS PUBLISHED BY  
 MARK SET  VALUES ESTABLISHED BY Patrick Engineering Inc. **DATE** August, 2002

**HORIZONTAL VALUES ORIGINATED ON ORDER "B" IOWA HIGH ACCURACY REFERENCE NETWORK (HARN) CONTROL ESTABLISHED BY THE NATIONAL GEODETIC SURVEY AND BASED ON THE NORTH AMERICAN DATUM OF 1983, 1996 ADJUSTMENT.**

**LATITUDE NORTH** 43° 17' 56.149684"  
**LONGITUDE WEST** 95° 16' 09.739659"  
**ELLIPSOID HEIGHT (meter)** 409.825 \* (Based on GEOID99 Model)

**IOWA COORDINATE SYSTEM, NORTH ZONE** **CONVERGENCE ANGLE** -1° 11' 57.06"  
**COORDINATES (US FEET)** **SCALE FACTOR** 0.999942  
**NORTHING (Y)** 3941360.03 **COORDINATES (METERS)**  
**EASTING (X)** 4450236.13 **NORTHING (Y)** 1201328.940  
**EASTING (X)** 1356434.685

**VERTICAL VALUES ORIGINATED ON VERTICAL CONTROL ESTABLISHED BY THE NATIONAL GEODETIC SURVEY AND/OR THE U.S. GEOLOGICAL SURVEY AND BASED ON THE NORTH AMERICAN VERTICAL DATUM OF 1988.**

**ELEVATION (US FEET)** 1436.34 **ELEVATION (METERS)** 437.797

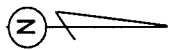
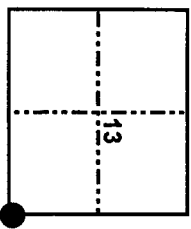
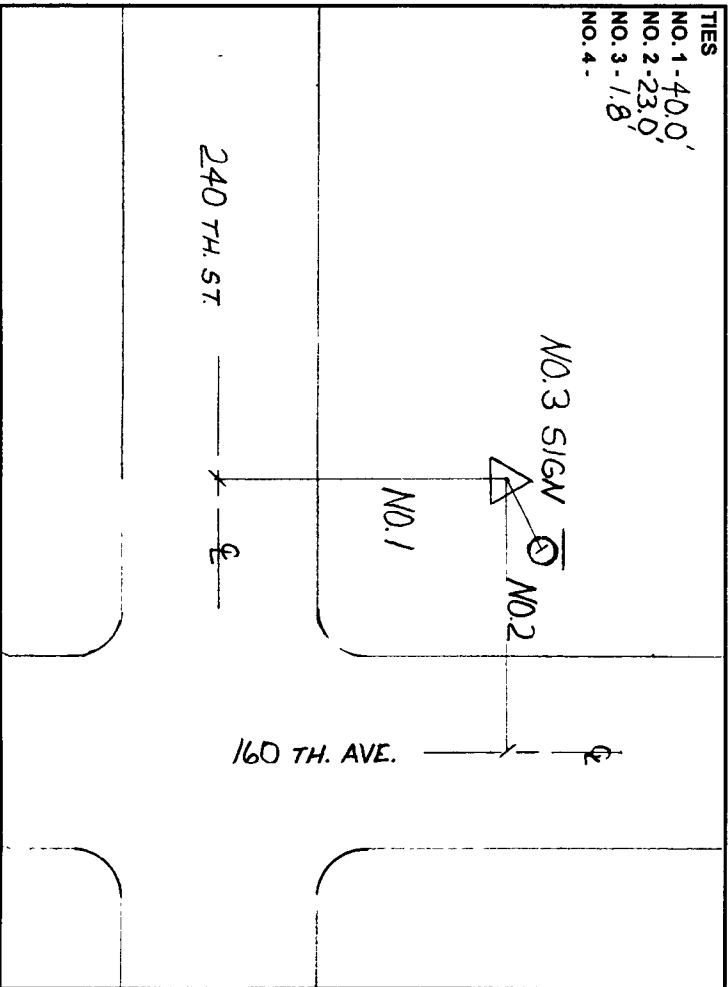

**SKETCH**  
**BY** CCS  
**PATRICK 09-2002**