

GPS SURVEY MARK DESCRIPTION

GIS MAPPING BY:
 THE SIDWELL COMPANY
 WEST CHICAGO, ILLINOIS

THE OFFICE OF THE
 COUNTY ENGINEER
 DICKINSON COUNTY, IOWA

DESIGNATION 1003724 2 GPS NO. 8026 COUNTY DICKINSON STATE IOWA
 LOCATED IN SECTION 24 TWP 100 N RANGE 37 W USGS QUAD MAP OKOBOJI
 TO REACH THE STATION FROM _____
 THE INTERSECTION OF 215TH AVENUE AND 125TH STREET. HEAD EAST ON 125TH STREET FOR APPROXIMATELY
225.0 FEET TO THE STATION ON THE RIGHT.

MARK BERNTSEN MONUMENT WITH 2-1/2" ALUMINUM DISK ON ROD WITH 6" ACCESS COVER
 MARK EXISTING VALUES AS PUBLISHED BY
 MARK SET VALUES ESTABLISHED BY Patrick Engineering Inc. DATE August, 2002

HORIZONTAL VALUES ORIGINATED ON ORDER "B" IOWA HIGH ACCURACY REFERENCE NETWORK (HARN) CONTROL ESTABLISHED BY THE NATIONAL GEODETIC SURVEY AND BASED ON THE NORTH AMERICAN DATUM OF 1983, 1996 ADJUSTMENT.

LATITUDE NORTH 43° 27' 59.398750"
 LONGITUDE WEST 95° 09' 35.905325"
 ELLIPSOID HEIGHT (meter) 417.244 * (Based on GEOID99 Model)

IOWA COORDINATE SYSTEM, NORTH ZONE
 CONVERGENCE ANGLE -1° 07' 30.14"
 SCALE FACTOR 0.999977
 COORDINATES (US FEET)
 NORTHING (Y) 4001838.20 COORDINATES (METERS)
 EASTING (X) 4480553.84 EASTING (X) 1219762.723
1365675.542

VERTICAL VALUES ORIGINATED ON VERTICAL CONTROL ESTABLISHED BY THE NATIONAL GEODETIC SURVEY AND/OR THE U.S. GEOLOGICAL SURVEY AND BASED ON THE NORTH AMERICAN VERTICAL DATUM OF 1988.

ELEVATION (US FEET) 1459.76 ELEVATION (METERS) 444.936

TIES
 NO. 1-225.0'
 NO. 2-32.0'
 NO. 3-22.0'
 NO. 4-4.5'

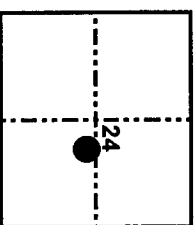
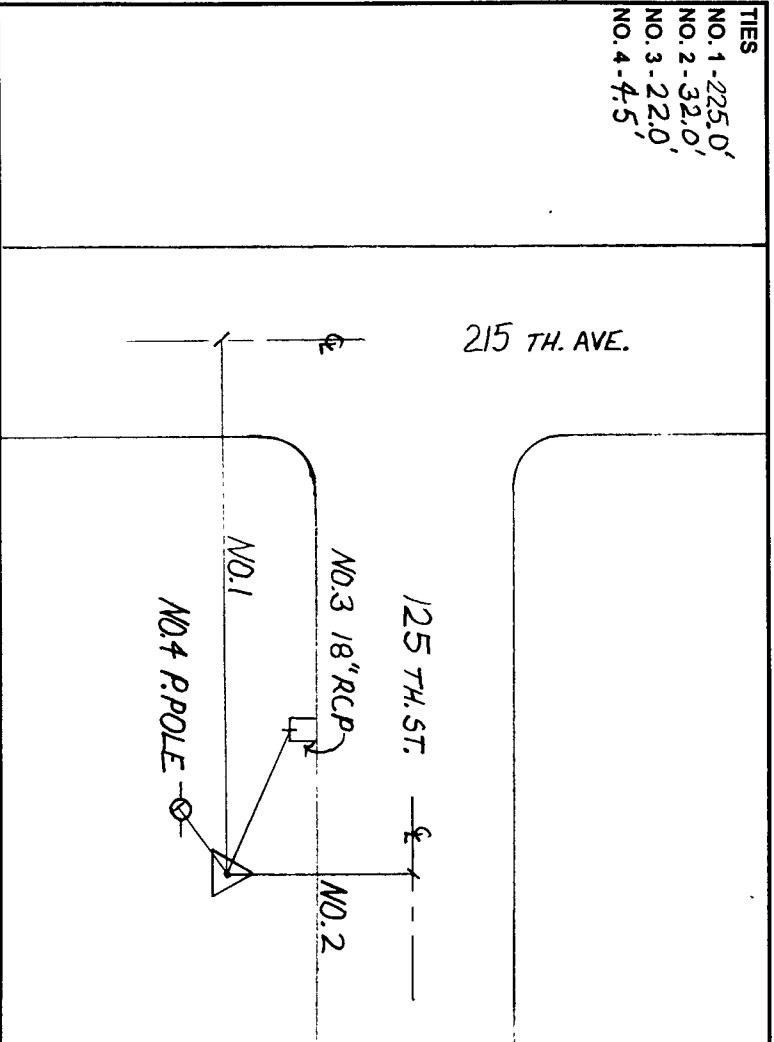

SECTION MAP



SKETCH BY CCS

PATRICK 09-2002