

GPS SURVEY MARK DESCRIPTION

GIS MAPPING BY:
THE SIDWELL COMPANY
WEST CHICAGO, ILLINOIS

THE OFFICE OF THE
COUNTY ENGINEER
DICKINSON COUNTY, IOWA

DESIGNATION 993618 3 **GPS NO.** 8028 **COUNTY** DICKINSON **STATE** IOWA
LOCATED IN SECTION 18 **TWP** 99 N **RANGE** 36 W **USGS QUAD MAP** OKOBUJ
THE STATION IS AT
THE INTERSECTION OF SANBORN AVENUE AND FURLAM STREET. THE STATION IS ON THE NORTH SIDE OF SANBORN
ROAD AND IN THE CENTER MEDIAN OF THE ENTRANCE TO SPIRIT LAKE AIRPORT.

MARK BERNTSEN MONUMENT WITH 2-1/2" ALUMINUM DISK ON ROD WITH 6" ACCESS COVER
 MARK EXISTING **VALUES AS PUBLISHED BY** Patrick Engineering Inc. **DATE** August, 2002
 MARK SET **VALUES ESTABLISHED BY**

HORIZONTAL VALUES ORIGINATED ON ORDER "B" IOWA HIGH ACCURACY REFERENCE NETWORK (HARN) CONTROL ESTABLISHED BY THE NATIONAL GEODETIC SURVEY AND BASED ON THE NORTH AMERICAN DATUM OF 1983, 1996 ADJUSTMENT.

LATITUDE NORTH 43° 22' 56.470552"
LONGITUDE WEST 95° 08' 21.419064"
ELLIPSOID HEIGHT (meter) 404.198 * (Based on GEOID99 Model)

IOWA COORDINATE SYSTEM, NORTH ZONE **CONVERGENCE ANGLE** -1° 06' 39.65"
COORDINATES (US FEET) **SCALE FACTOR** 0.9999960
NORTHING (Y) 3971063.96 **COORDINATES (METERS)**
EASTING (X) 4485451.44 **NORTHING (Y)** 1210382.716
EASTING (X) 1367168.333

VERTICAL VALUES ORIGINATED ON VERTICAL CONTROL ESTABLISHED BY THE NATIONAL GEODETIC SURVEY AND/OR THE U.S. GEOLOGICAL SURVEY AND BASED ON THE NORTH AMERICAN VERTICAL DATUM OF 1988.

ELEVATION (US FEET) 1417.87 **ELEVATION (METERS)** 432.168

TIES
NO. 1 - 11
NO. 2 - 19,5
NO. 3 - 16,8
NO. 4 - 10,5

*paved parking lot
to Spirit Lake
to Airport*

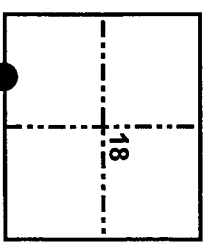
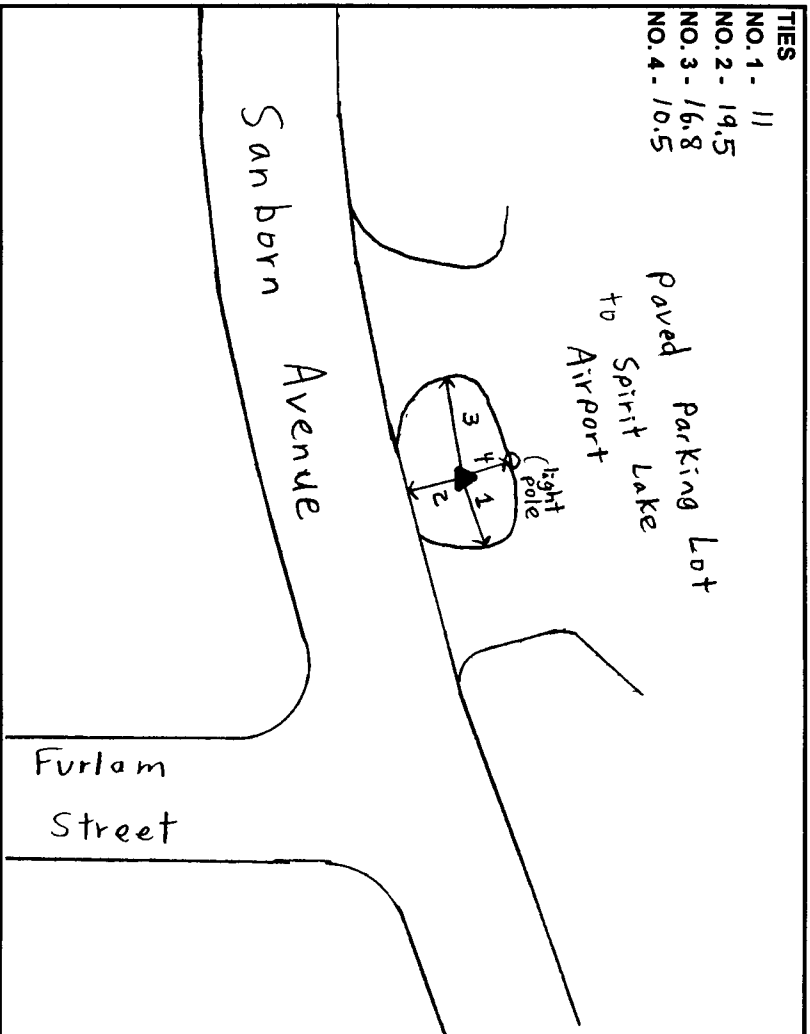

SECTION MAP

SKETCH BY CCS

PATRICK 09-2002