

**GPS SURVEY MARK DESCRIPTION**

GIS MAPPING BY:  
 THE SIDWELL COMPANY  
 WEST CHICAGO, ILLINOIS

THE OFFICE OF THE  
 COUNTY ENGINEER  
 DICKINSON COUNTY, IOWA

DESIGNATION 983713 2 GPS NO. 8030 COUNTY DICKINSON STATE IOWA  
 LOCATED IN SECTION 13 TWP 98 N RANGE 37 W USGS QUAD MAP MILFORD  
 THE STATION IS \_\_\_\_\_  
 DUE NORTH OF THE INTERSECTION BETWEEN 240TH STREET AND U.S. HIGHWAY 71 IN THE CENTER MEDIAN.

MARK BERNTSEN MONUMENT WITH 2-1/2" ALUMINUM DISK ON ROD WITH 6" ACCESS COVER

MARK EXISTING  VALUES AS PUBLISHED BY \_\_\_\_\_  
 MARK SET  VALUES ESTABLISHED BY Patrick Engineering Inc. DATE August, 2002

HORIZONTAL VALUES ORIGINATED ON ORDER "B" IOWA HIGH ACCURACY REFERENCE NETWORK (HARN) CONTROL ESTABLISHED BY THE NATIONAL GEODETIC SURVEY AND BASED ON THE NORTH AMERICAN DATUM OF 1983, 1996 ADJUSTMENT.

LATITUDE NORTH 43° 17' 57.039983"  
 LONGITUDE WEST 95° 09' 00.441943"  
 ELLIPSOID HEIGHT (meter) 407.331 \*(Based on GEOID99 Model)

IOWA COORDINATE SYSTEM, NORTH ZONE  
 CONVERGENCE ANGLE -1° 07' 06.1"  
 SCALE FACTOR 0.999942  
 COORDINATES (US FEET)  
 NORTHING (Y) 3940808.14 COORDINATES (METERS)  
 EASTING (X) 4481978.37 NORTHING (Y) 1201160.723  
 EASTING (X) 1366109.739

VERTICAL VALUES ORIGINATED ON VERTICAL CONTROL ESTABLISHED BY THE NATIONAL GEODETIC SURVEY AND/OR THE U.S. GEOLOGICAL SURVEY AND BASED ON THE NORTH AMERICAN VERTICAL DATUM OF 1988.

ELEVATION (US FEET) 1428.92 ELEVATION (METERS) 435.536

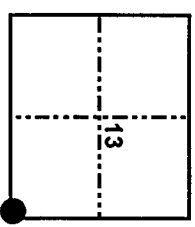
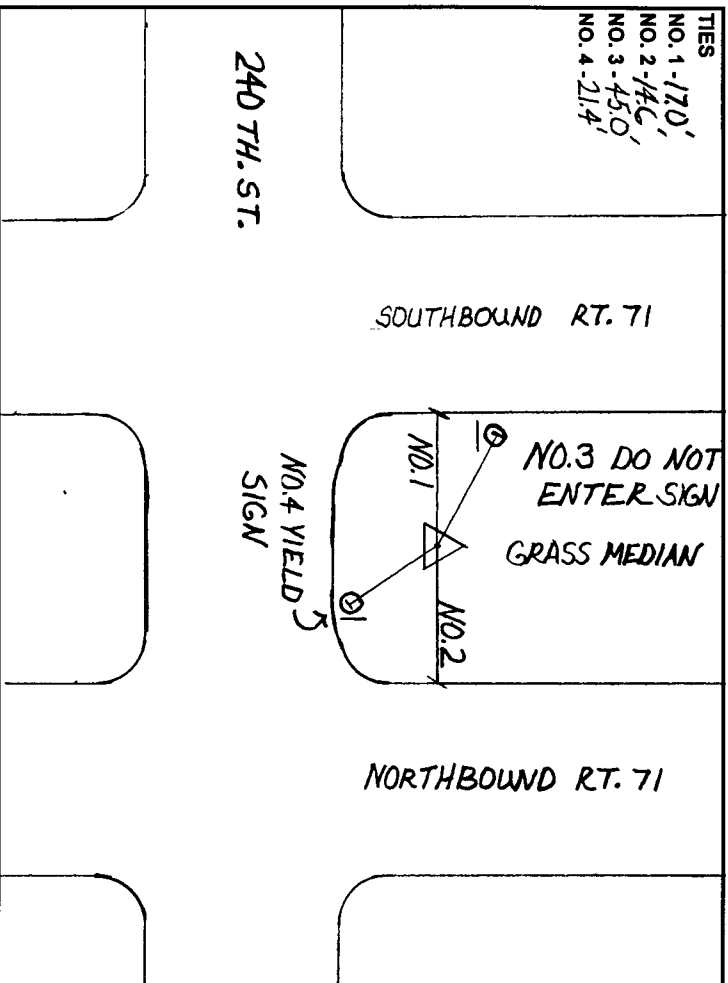

SECTION MAP

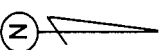

SKETCH BY CCS  
 PATRICK 09-2002