

GPS SURVEY MARK DESCRIPTION

GIS MAPPING BY:
 THE SIDWELL COMPANY
 WEST CHICAGO, ILLINOIS

THE OFFICE OF THE
 COUNTY ENGINEER
 DICKINSON COUNTY, IOWA

DESIGNATION 1013531 3 GPS NO. 8031 COUNTY DICKINSON STATE IOWA
 LOCATED IN SECTION 31 TWP 101 N RANGE 35 W USGS QUAD MAP LAKEFIELD SE
 THE STATION IS
 AT THE NORTHEAST CORNER OF THE INTERSECTION BETWEEN 100TH STREET AND JACKSON COUNTY ROAD 75

MARK BERNTSEN MONUMENT WITH 2-1/2" ALUMINUM DISK ON ROD WITH 6" ACCESS COVER

MARK EXISTING VALUES AS PUBLISHED BY Patrick Engineering Inc. DATE Augusl, 2002
 MARK SET VALUES ESTABLISHED BY

HORIZONTAL VALUES ORIGINATED ON ORDER "B" IOWA HIGH ACCURACY REFERENCE NETWORK (HARN) CONTROL ESTABLISHED BY THE NATIONAL GEODETIC SURVEY AND BASED ON THE NORTH AMERICAN DATUM OF 1983, 1996 ADJUSTMENT.

LATITUDE NORTH 43° 30' 04.537011"
 LONGITUDE WEST 95° 05' 37.728630"
 ELLIPSOID HEIGHT (meter) 403.634 * (Based on GEOID99 Model)

IOWA COORDINATE SYSTEM, NORTH ZONE
 CONVERGENCE ANGLE -1° 04' 48.71"
 SCALE FACTOR 0.999988
 COORDINATES (US FEET)
 NORTHING (Y) 4014169.04 COORDINATES (METERS)
 NORTHING (Y) 1223521.170
 EASTING (X) 4498355.05 EASTING (X) 1371101.361

VERTICAL VALUES ORIGINATED ON VERTICAL CONTROL ESTABLISHED BY THE NATIONAL GEODETIC SURVEY AND/OR THE U.S. GEOLOGICAL SURVEY AND BASED ON THE NORTH AMERICAN VERTICAL DATUM OF 1988.

ELEVATION (US FEET) 1415.15 ELEVATION (METERS) 431.339

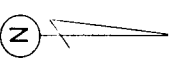
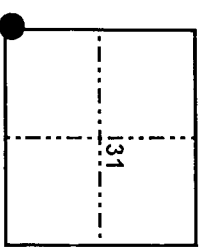
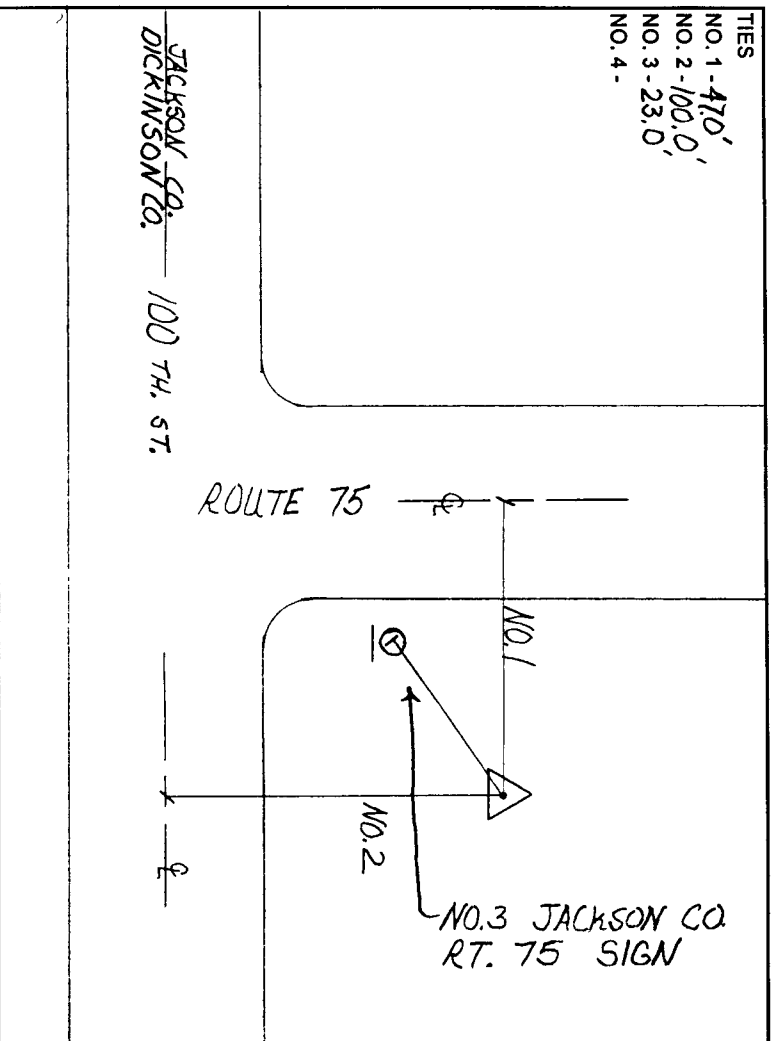

SKETCH BY RS

PATRICK 09-2002