

GPS SURVEY MARK DESCRIPTION

GIS MAPPING BY:
THE SIDWELL COMPANY
 WEST CHICAGO, ILLINOIS

THE OFFICE OF THE
COUNTY ENGINEER
 DICKINSON COUNTY, IOWA

DESIGNATION 983616 2 **GPS NO.** 8036 **COUNTY** DICKINSON **STATE** IOWA
LOCATED IN SECTION 16 **TWP** 98 N **RANGE** 36 W **USGS QUAD MAP** SPIRIT LAKE SE
THE STATION IS _____
AT THE NORTHWEST CORNER OF THE INTERSECTION BETWEEN 240TH STREET AND 250TH AVENUE

MARK BERNTSEN MONUMENT WITH 2-1/2" ALUMINUM DISK ON ROD WITH 6" ACCESS COVER

MARK EXISTING VALUES AS PUBLISHED BY _____ **DATE** August, 2002
 MARK SET VALUES ESTABLISHED BY Patrick Engineering Inc.

HORIZONTAL VALUES ORIGINATED ON ORDER "B" IOWA HIGH ACCURACY REFERENCE NETWORK (HARN) CONTROL ESTABLISHED BY THE NATIONAL GEODETIC SURVEY AND BASED ON THE NORTH AMERICAN DATUM OF 1983, 1996 ADJUSTMENT.

LATITUDE NORTH 43° 17' 56.469066"
LONGITUDE WEST 95° 05' 33.024641"
ELLIPSOID HEIGHT (meter) 414.384 * (Based on GEOID99 Model)

IOWA COORDINATE SYSTEM, NORTH ZONE **CONVERGENCE ANGLE** -1° 04' 45.53"
COORDINATES (US FEET) **SCALE FACTOR** 0.999941
NORTHING (Y) 3940456.19 **COORDINATES (METERS)** **NORTHING (Y)** 1201053.449
EASTING (X) 4497313.10 **EASTING (X)** 1370783.774

VERTICAL VALUES ORIGINATED ON VERTICAL CONTROL ESTABLISHED BY THE NATIONAL GEODETIC SURVEY AND/OR THE U.S. GEOLOGICAL SURVEY AND BASED ON THE NORTH AMERICAN VERTICAL DATUM OF 1988.

ELEVATION (US FEET) 1452.32 **ELEVATION (METERS)** 442.668

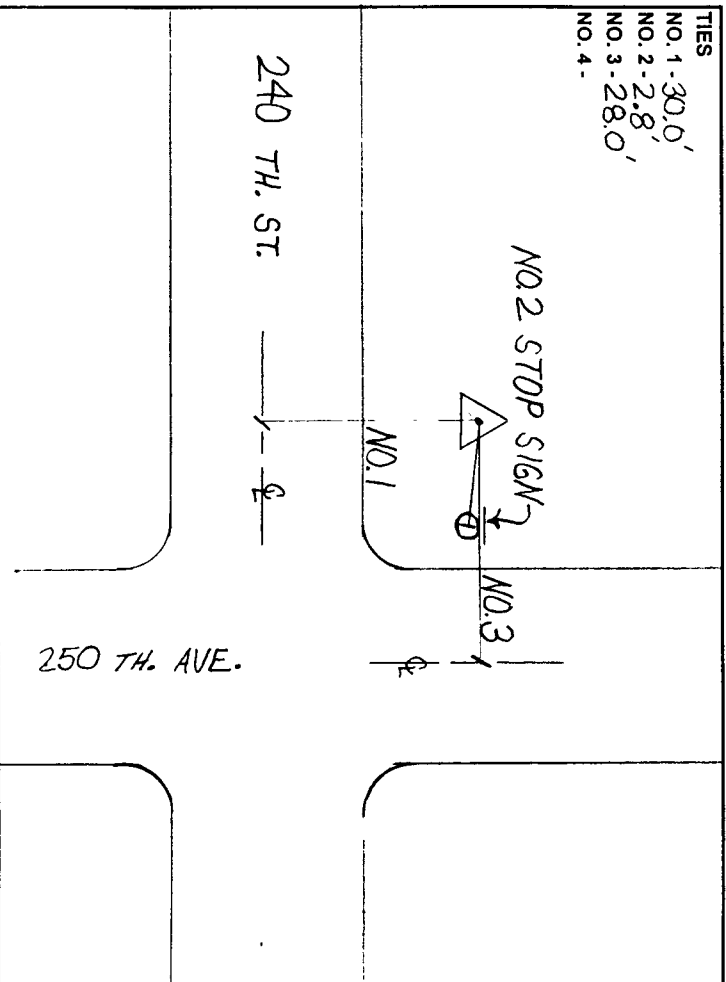

TIES
 NO. 1 - 30.0'
 NO. 2 - 2.8'
 NO. 3 - 28.0'
 NO. 4 - _____

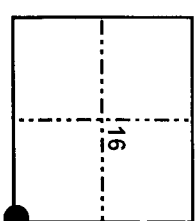

SECTION MAP

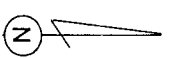

SKETCH BY CCS
 PATRICK 09-2002