

GPS SURVEY MARK DESCRIPTION

GIS MAPPING BY:
 THE SIDWELL COMPANY
 WEST CHICAGO, ILLINOIS

THE OFFICE OF THE
 COUNTY ENGINEER
 DICKINSON COUNTY, IOWA

DESIGNATION 1013638 2 GPS NO. 8037 COUNTY JACKSON STATE MN
 LOCATED IN SECTION 38 TWP 101 N RANGE 36 W USGS QUAD MAP _____
 THE STATION IS _____
 DUE NORTH OF THE INTERSECTION BETWEEN 100TH STREET AND 280TH AVENUE.

MARK BERNTSEN MONUMENT WITH 2-1/2" ALUMINUM DISK ON ROD WITH 6" ACCESS COVER
 MARK EXISTING VALUES AS PUBLISHED BY _____
 MARK SET VALUES ESTABLISHED BY Patrick Engineering Inc. DATE August, 2002

HORIZONTAL VALUES ORIGINATED ON ORDER "B" IOWA HIGH ACCURACY REFERENCE NETWORK (HARN) CONTROL ESTABLISHED BY THE NATIONAL GEODETIC SURVEY AND BASED ON THE NORTH AMERICAN DATUM OF 1983, 1996 ADJUSTMENT.

LATITUDE NORTH 43° 30' 03.627923"
 LONGITUDE WEST 95° 01' 57.277961"
 ELLIPSOID HEIGHT (meter) 402.414 * (Based on GEOID99 Model)

IOWA COORDINATE SYSTEM, NORTH ZONE
 CONVERGENCE ANGLE -1° 02' 19.31"
 SCALE FACTOR 0.999988
 COORDINATES (US FEET)
 NORTHING (Y) 4013776.56 NORTHING (METERS) 1223401.542
 EASTING (X) 4514599.72 EASTING (X) 1376052.747

VERTICAL VALUES ORIGINATED ON VERTICAL CONTROL ESTABLISHED BY THE NATIONAL GEODETIC SURVEY AND/OR THE U.S. GEOLOGICAL SURVEY AND BASED ON THE NORTH AMERICAN VERTICAL DATUM OF 1988.

ELEVATION (US FEET) 1411.42 ELEVATION (METERS) 430.202

TIES
 NO. 1 - 79.0'
 NO. 2 - 7.5'
 NO. 3 - 26.0'
 NO. 4 -

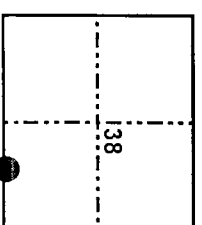
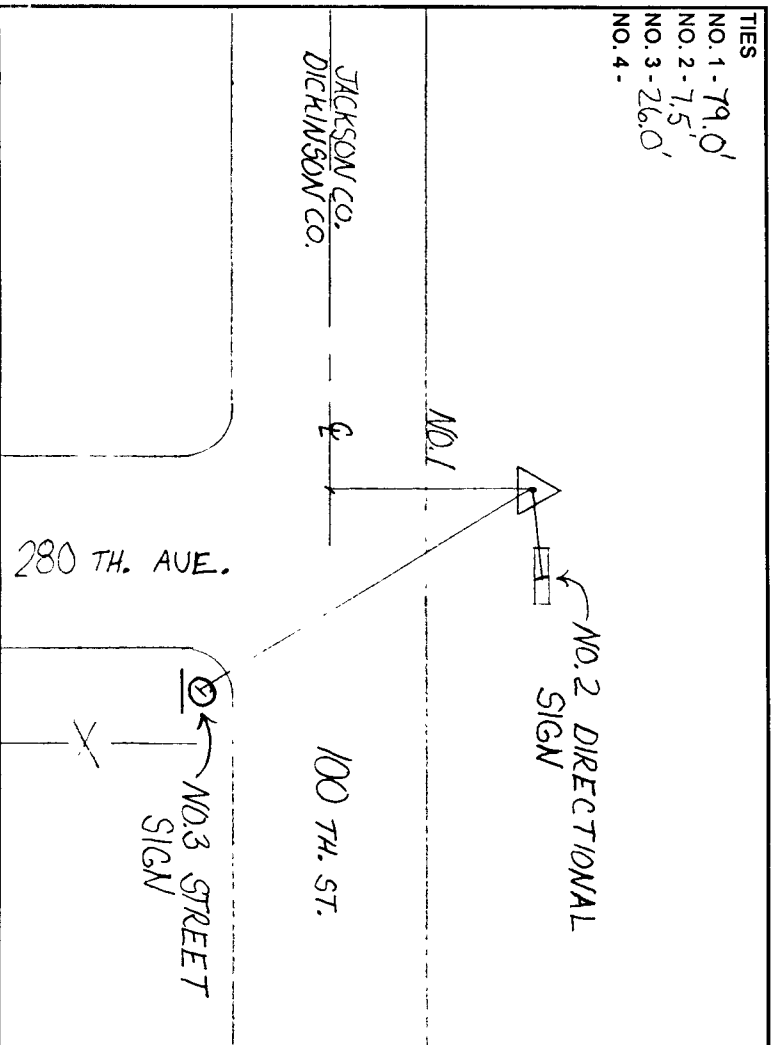

SECTION MAP

SKETCH BY CCS

PATRICK 09-2002