

GPS SURVEY MARK DESCRIPTION

GIS MAPPING BY:
 THE SIDWELL COMPANY
 WEST CHICAGO, ILLINOIS

THE OFFICE OF THE
 COUNTY ENGINEER
 DICKINSON COUNTY, IOWA

DESIGNATION 1003522 3 GPS NO. 8044 COUNTY DICKINSON STATE IOWA
 LOCATED IN SECTION 22 TWP 100 N RANGE 35 W USGS QUAD MAP SUPERIOR
 TO REACH THE STATION FROM
THE INTERSECTION BETWEEN 310TH AVENUE AND 130TH STREET, HEAD NORTH ON 310TH AVENUE FOR 0.49 MILE
TO THE STATION ON THE RIGHT.

MARK BERNTSEN MONUMENT WITH 2-1/2" ALUMINUM DISK ON ROD WITH 6" ACCESS COVER
 MARK EXISTING VALUES AS PUBLISHED BY
 MARK SET VALUES ESTABLISHED BY Patrick Engineering Inc. DATE August, 2002

HORIZONTAL VALUES ORIGINATED ON ORDER "B" IOWA HIGH ACCURACY REFERENCE NETWORK (HARN) CONTROL ESTABLISHED BY THE NATIONAL GEODETIC SURVEY AND BASED ON THE NORTH AMERICAN DATUM OF 1983, 1996 ADJUSTMENT.

LATITUDE NORTH 43° 28' 00.231622"
 LONGITUDE WEST 94° 58' 27.202246"
 ELLIPSOID HEIGHT (meter) 415.211 * (Based on GEOID99 Model)

IOWA COORDINATE SYSTEM, NORTH ZONE	CONVERGENCE ANGLE <u>0° 59' 56.93"</u>
COORDINATES (US FEET)	SCALE FACTOR <u>0.999978</u>
NORTHING (Y) <u>4001008.38</u>	COORDINATES (METERS)
EASTING (X) <u>4529863.84</u>	NORTHING (Y) <u>1219509.793</u>
	EASTING (X) <u>1380705.260</u>

VERTICAL VALUES ORIGINATED ON VERTICAL CONTROL ESTABLISHED BY THE NATIONAL GEODETIC SURVEY AND/OR THE U.S. GEOLOGICAL SURVEY AND BASED ON THE NORTH AMERICAN VERTICAL DATUM OF 1988.

ELEVATION (US FEET) 1453.91 ELEVATION (METERS) 443.153

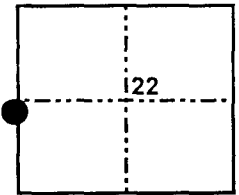
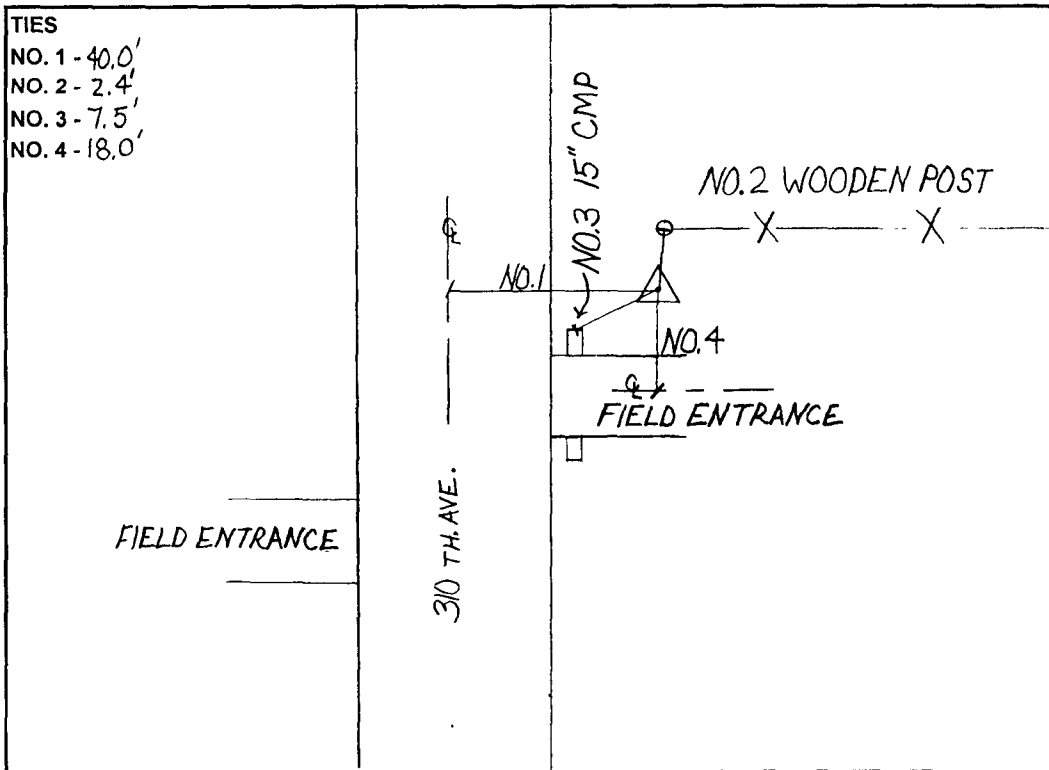

SECTION MAP



SKETCH BY CCS

PATRICK 09-2002