

**Fremont County, Iowa**

Horizontal Datum: **NAD 83(2011)** - Vertical Datum: **NAVD 1988**  
Iowa State Plane South Zone (1402)  
Iowa Regional Coordinate System Zone 6 Council Bluffs  
US Survey Feet  
**2015**

Point Name: **1024**

**Designation:** CBN & PACS horiz. control station "N21 B" PID:AB4135

NAD 83(NA2011) Latitude: **N40°36'27.05898"** Longitude: **W95°51'56.48750"**  
NAVD 88 Ortho Height: **1159.210sft** Ellip. Ht: **1063.088sft** **Geoid12A**

Iowa South Zone (1402) Northing: **230269.877sft** Easting: **983628.365sft**  
Mapping Angle: **-1°33'30"** Combination Scale Factor: **0.999950899**

IaRCS Zone 6 Northing: **6730280.646sft** Easting: **16463247.555sft**  
Mapping Angle: **-0°05'10"** Combination Scale Factor: **0.999989813**

**Monument Type:** The station is a stainless steel rod in a sleeve.

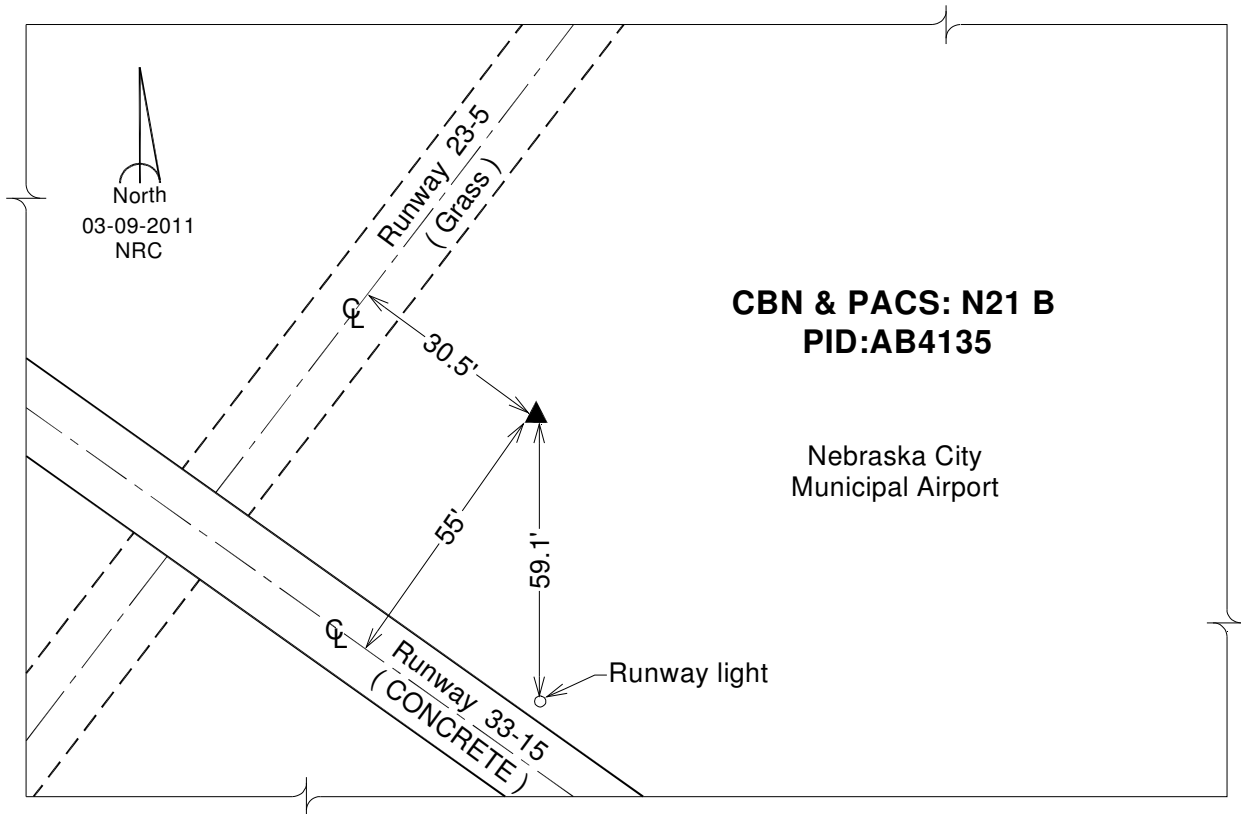

*This document was prepared by DCI on January 9, 2015 for use by Fremont County, Iowa*