

GPS SURVEY MARK DESCRIPTION

GIS MAPPING BY:
THE SIDWELL COMPANY
WEST CHICAGO, ILLINOIS

THE OFFICE OF THE
COUNTY ENGINEER
WEBSTER COUNTY, IOWA

DESIGNATION 862936 2 GPS No. 6081 COUNTY WEBSTER STATE IOWA
 LOCATED IN SECTION 36 TWP 86 N RGE 29 W USGS QUAD MAP LANYON
 TO REACH FROM THE INTERSECTION OF MADISON AVENUE AND 400TH STREET, AT THE WEBSTER -
GREENE COUNTY LINE: GO WEST 0.1 MILES TO MARK.

TYPE OF MARK BERNTSEN TOP SECURITY ROD WITH 3-1/4" ALUMINUM CAP SET INSIDE ACCESS COVER

RECOVERED SET BY DENI ASSOCIATES, INC., FT. MYERS, FL DATE AUGUST 1996

HORIZONTAL VALUES ORIGINATED ON ORDER "B" IOWA HIGH ACCURACY REFERENCE NETWORK (HARN) CONTROL ESTABLISHED BY THE NATIONAL GEODETIC SURVEY AND BASED ON THE NORTH AMERICAN DATUM OF 1983, 1996 ADJUSTMENT.

IOWA COORDINATE SYSTEM, NORTH ZONE SCALE FACTOR: 0.99997706

COORDINATES (US FEET)		COORDINATES (METERS)	
NORTHING (Y)	<u>3540299.71</u>	NORTHING (Y)	<u>1079085.511</u>
EASTING (X)	<u>4740503.76</u>	EASTING (X)	<u>1444908.436</u>

VERTICAL VALUES ORIGINATED ON VERTICAL CONTROL ESTABLISHED BY THE NATIONAL GEODETIC SURVEY AND/OR THE U.S. GEOLOGICAL SURVEY AND BASED ON THE NORTH AMERICAN VERTICAL DATUM OF 1988.

ELEVATION (US FEET) 1152.57 ELEVATION (METERS) 351.303

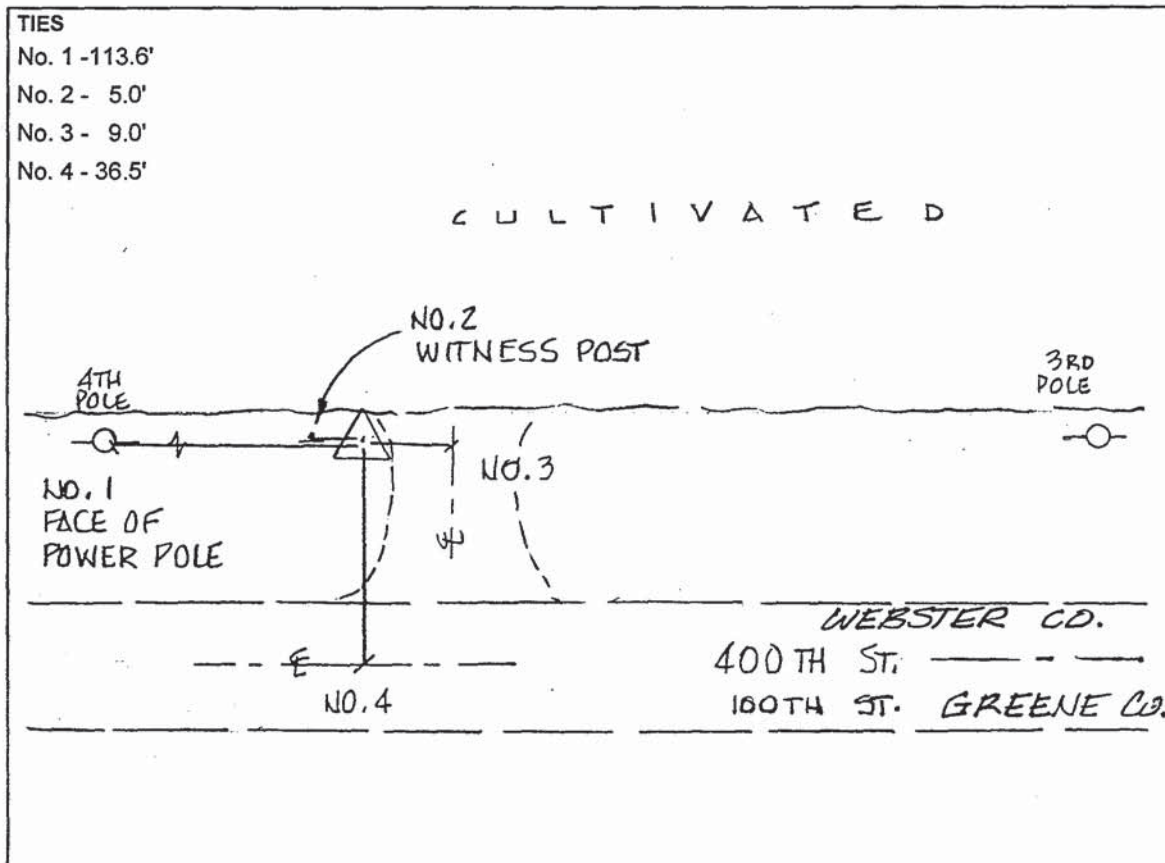

SKETCH
BY DSW
DENI 9605023