

GPS SURVEY MARK DESCRIPTION

GIS MAPPING BY:
THE SIDWELL COMPANY
WEST CHICAGO, ILLINOIS

THE OFFICE OF THE
COUNTY ENGINEER
GREENE COUNTY, IOWA

DESIGNATION 843131 3 GPS No. A038 COUNTY GREENE STATE IOWA

LOCATED IN SECTION 31 TWP 84 N RGE 31 W USGS QUAD MAP SCRANTON

TO REACH FROM _____

AT THE INTERSECTION OF U.S. HIGHWAY 30 AND G AVENUE, IN THE NORTHEAST QUADRANT.

IN BRISTOL TOWNSHIP

MARK 3-1/4" ALUMINUM DISC SET IN 10" DIAMETER POURED-IN-PLACE CONCRETE MONUMENT

MARK EXISTING VALUES AS PUBLISHED BY _____

MARK SET VALUES ESTABLISHED BY DENI ASSOCIATES, INC. DATE OCTOBER 2000

HORIZONTAL VALUES ORIGINATED ON ORDER "B" IOWA HIGH ACCURACY REFERENCE NETWORK (HARN) CONTROL ESTABLISHED BY THE NATIONAL GEODETIC SURVEY AND BASED ON THE NORTH AMERICAN DATUM OF 1983, 1996 ADJUSTMENT.

IOWA COORDINATE SYSTEM, NORTH ZONE SCALE FACTOR: 1.00000591

COORDINATES (US FEET) COORDINATES (METERS)

NORTHING (Y) 3477432.91 NORTHING (Y) 1059923.670

EASTING (X) 4646048.76 EASTING (X) 1416118.494

VERTICAL VALUES ORIGINATED ON VERTICAL CONTROL ESTABLISHED BY THE NATIONAL GEODETIC SURVEY AND/OR THE U.S. GEOLOGICAL SURVEY AND BASED ON THE NORTH AMERICAN VERTICAL DATUM OF 1988.

ELEVATION (US FEET) 1114.26 ELEVATION (METERS) 339.63

- TIES
No. 1 - 39.0'
No. 2 - 107.2'
No. 3 - 29.8'
No. 4 - 2.5'

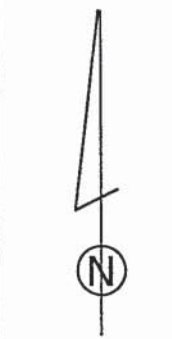
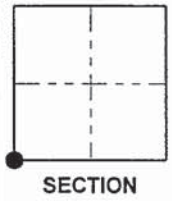
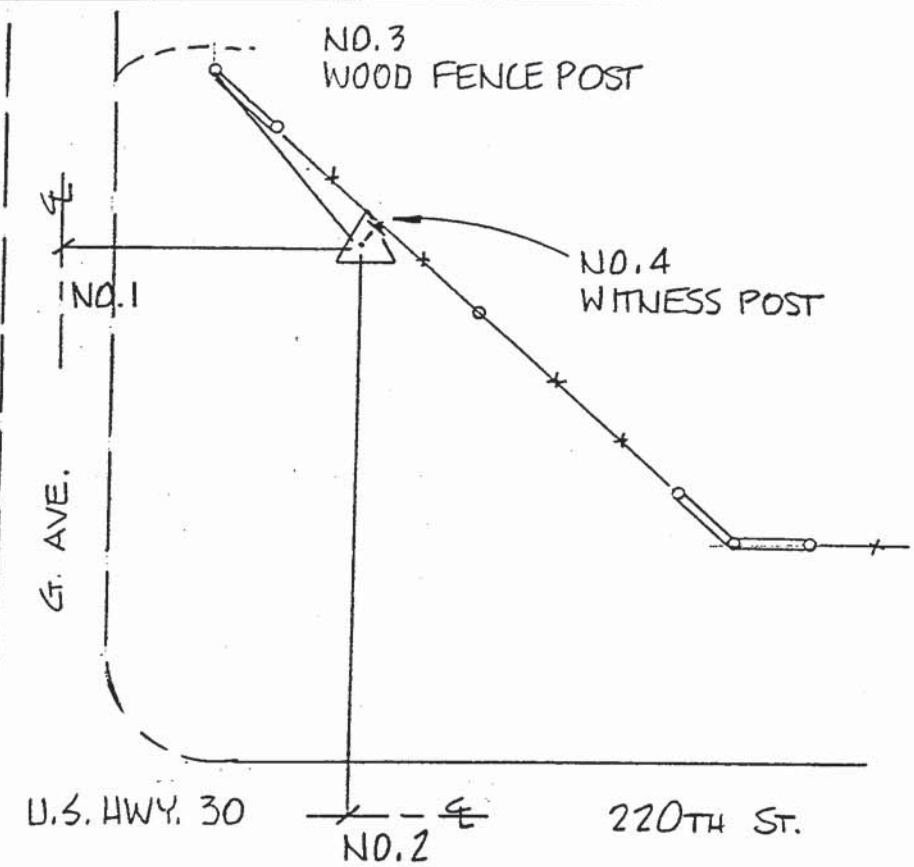

SKETCH
BY DSW
20000204