

Grundy County, Iowa
 Horizontal Datum: **NAD 83(NA2011)** - Vertical Datum: **NAVD 1988**
 Iowa State Plane North Zone (1401)
 Iowa Regional Coordinate System, Zone 5, Waterloo LCC
 US Survey Feet
09/30/18

Point Name: **7052**

Designation: Grundy Co 7052 (Set by Deni Associates in 1997)

NAD 83(NA2011) Latitude: **N42°30'36.23658"** Longitude: **W92°43'52.42746"**
 NAVD 88 Ortho Height: **1045.870sft** Ellip. Ht: **941.397sft** Geoid12B

Iowa North Zone (1401) Northing: **3649866.163sft** Easting: **5128526.244sft**
 Mapping Angle: **0°31'16"** Combination Scale Factor: **0.9999041359**

IaRCS Zone 5 Northing: **8849368.485sft** Easting: **15370238.309sft**
 Mapping Angle: **-0°19'34"** Combination Scale Factor: **0.9999899687**

Monument Type: 3-1/4" aluminum disk set in the top of a 12" dia. poured-in-place concrete monument.

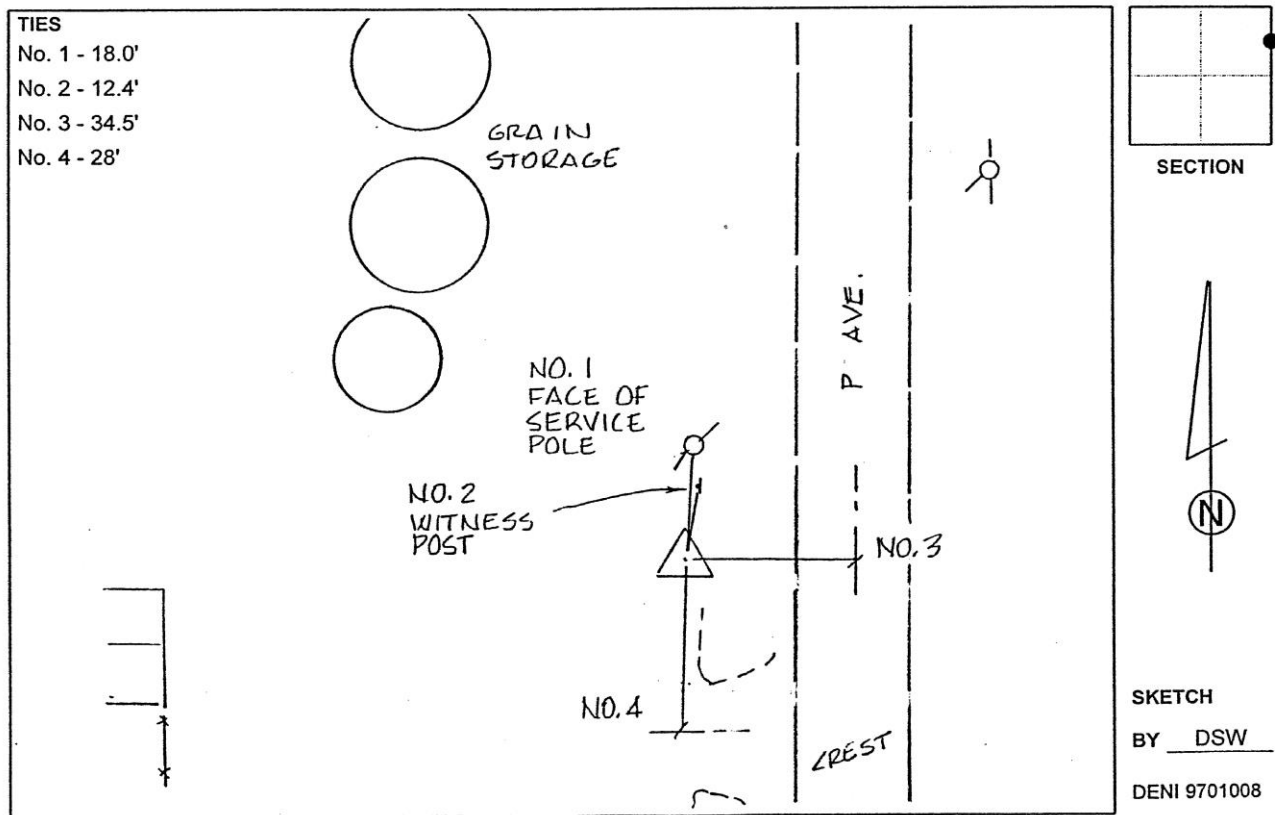

This document was prepared by Dan Corbin, Inc. on March 11th, 2019 for Grundy County, Iowa.