

**Grundy County, Iowa**  
 Horizontal Datum: **NAD 83(NA2011)** - Vertical Datum: **NAVD 1988**  
 Iowa State Plane North Zone (1401)  
 Iowa Regional Coordinate System, Zone 5, Waterloo LCC  
 US Survey Feet  
**09/30/18**

Point Name: **7083**

**Designation:** Grundy Co 7083 (Set by DCI in 2018)

NAD 83(NA2011) Latitude: **N42°28'10.15890"** Longitude: **W92°36'07.84562"**  
 NAVD 88 Ortho Height: **970.989sft** Ellip. Ht: **866.935sft** **Geoid12B**

**Iowa North Zone (1401)** Northing: **3635422.602sft** Easting: **5163476.743sft**  
 Mapping Angle: **0°36'31"** Combination Scale Factor: **0.9999098819**

**IaRCS Zone 5** Northing: **8834408.515sft** Easting: **15404974.435sft**  
 Mapping Angle: **-0°14'19"** Combination Scale Factor: **0.9999954985**

**Monument Type:** Berntsen "Top Security" aluminum rod monument with a 2-1/2" dia. survey cap and permanent magnet encased in a white PVC pipe with a NGS style aluminum access cover.

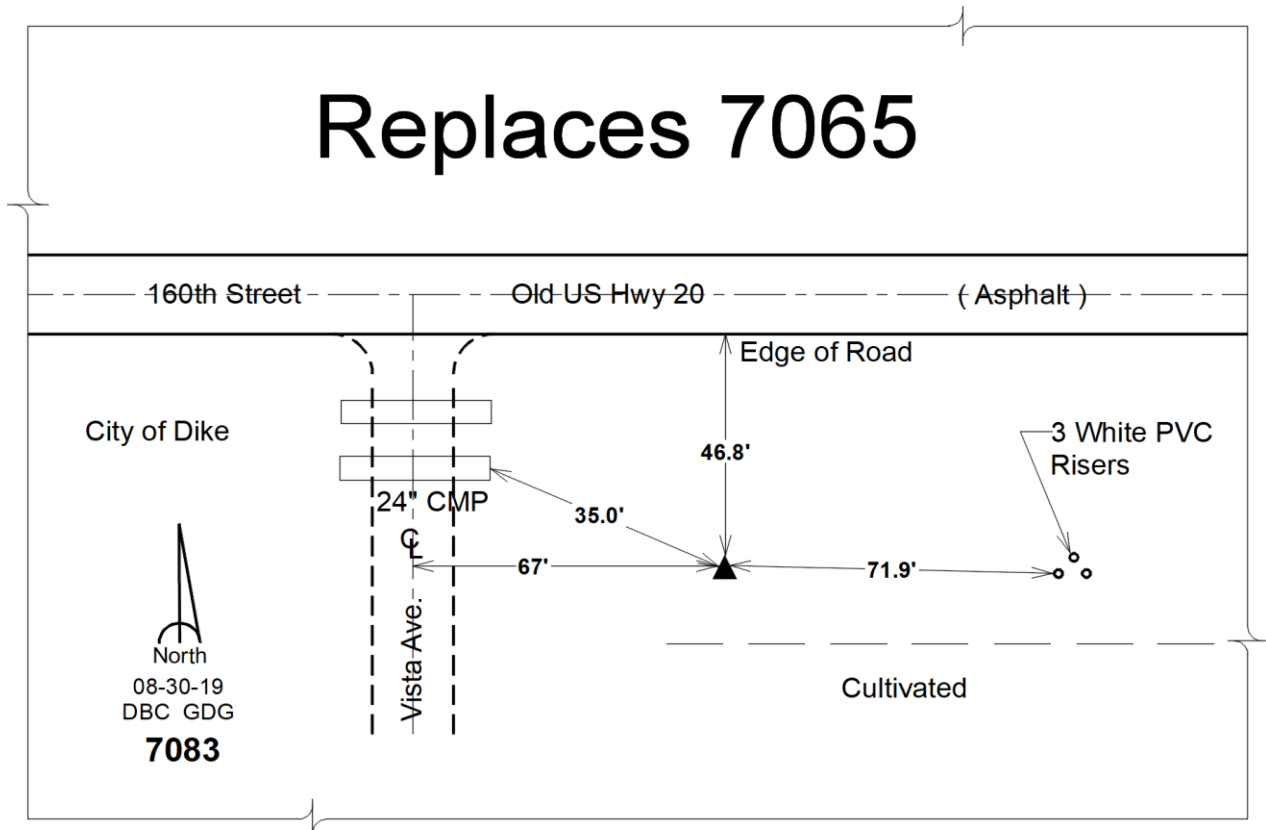

*This document was prepared by Dan Corbin, Inc. on March 11<sup>th</sup>, 2019 for Grundy County, Iowa.*