

Hancock County, Iowa

Horizontal Datum: **NAD 83(2011)** - Vertical Datum: **NAVD 1988**
Iowa State Plane North Zone (1401)
Iowa Regional Coordinate System, Zone 2. Mason City (LCC)
US Survey Feet
2015

Point Name: **1**

Designation: 97-001 HANCOCK CO GPS CONTROL PT (Set by ASI in 1997)

NAD 83(NA2011) Latitude: **N43°15'19.58100"** Longitude: **W93°58'13.10960"**
NAVD 88 Ortho Height: **1183.800sft** Ellip. Ht: **1088.320sft** **Geoid12A**

Iowa North Zone (1401) Northing: **3920926.921sft** Easting: **4795955.403sft**
Mapping Angle: **-0°19'07"** Combination Scale Factor: **0.999946044**

laRCS Zone 2 Northing: **9834726.678sft** Easting: **12174893.046sft**
Mapping Angle: **-00° 50' 05"** Combination Scale Factor: **0.999992084**

Monument Type: Existing Berntsen Top Security Rod Monument with a 2-1/2" dia. domed cap and a permanent magnet encased in a 5" dia. PVC pipe with a NGS style aluminum access cover.

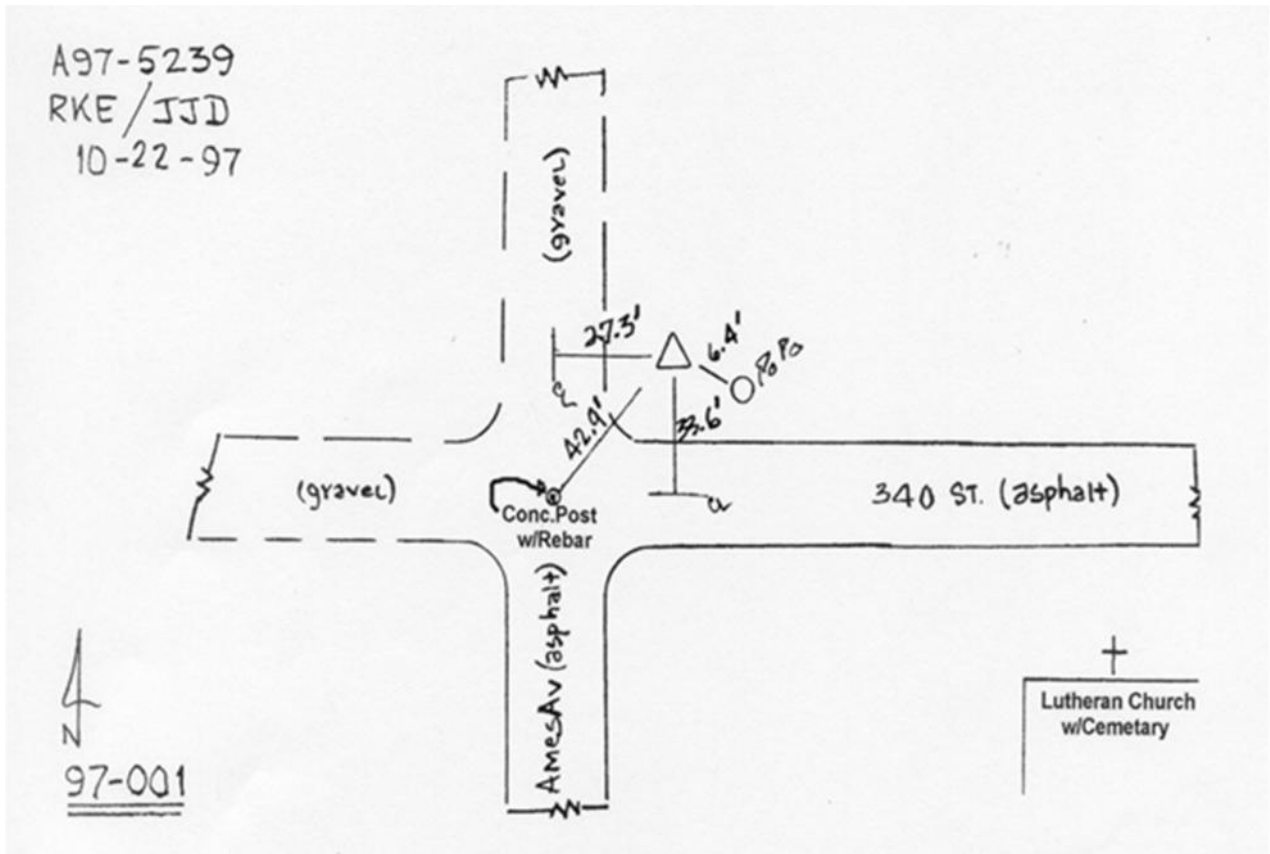

This document was prepared by Dan Corbin, Inc. on April 30, 2015 for Hancock County, Iowa.