

Hancock County, Iowa

Horizontal Datum: **NAD 83(2011)** - Vertical Datum: **NAVD 1988**
Iowa State Plane North Zone (1401)
Iowa Regional Coordinate System, Zone 2. Mason City (LCC)
US Survey Feet
2015

Point Name: **39**

Designation: 97-039 HANCOCK CO GPS CONTROL PT (Set by ASI in 1997)

NAD 83(NA2011) Latitude: **N42°57'55.64367"** Longitude: **W93°58'16.40798"**
NAVD 88 Ortho Height: **1179.820sft** Ellip. Ht: **1083.464sft** Geoid12A

Iowa North Zone (1401) Northing: **3815238.469sft** Easting: **4795122.190sft**
Mapping Angle: **-0°19'10"** Combination Scale Factor: **0.999907157**

laRCS Zone 2 Northing: **9729042.804sft** Easting: **12173107.763sft**
Mapping Angle: **-00° 50' 08"** Combination Scale Factor: **0.999997255**

Monument Type: Existing Berntsen Top Security Rod Monument with a 2-1/2" dia. domed cap and a permanent magnet encased in a 5" dia. PVC pipe with a NGS style aluminum access cover.

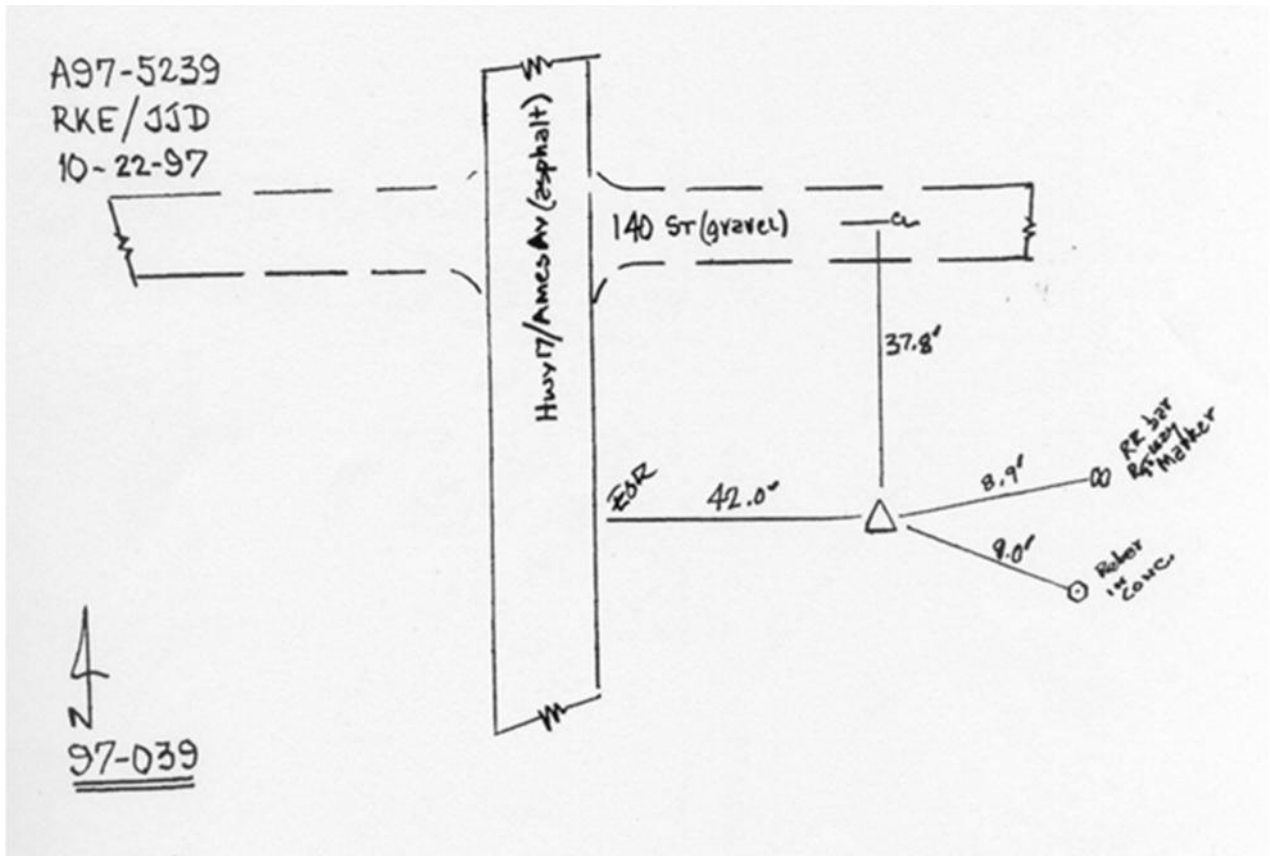

This document was prepared by Dan Corbin, Inc. on April 30, 2015 for Hancock County, Iowa.