

Hancock County, Iowa

Horizontal Datum: **NAD 83(2011)** - Vertical Datum: **NAVD 1988**
Iowa State Plane North Zone (1401)
Iowa Regional Coordinate System, Zone 2. Mason City (LCC)
US Survey Feet
2015

Point Name: **46**

Designation: 97-046 HANCOCK CO GPS CONTROL PT (Set by ASI in 1997)

NAD 83(NA2011) Latitude: **N42°54'31.70298"** Longitude: **W93°51'08.03672"**
NAVD 88 Ortho Height: **1147.950sft** Ellip. Ht: **1052.236sft** Geoid12A

Iowa North Zone (1401) Northing: **3794436.982sft** Easting: **4826885.323sft**
Mapping Angle: **-0°14'19"** Combination Scale Factor: **0.999904003**

laRCS Zone 2 Northing: **9707954.269sft** Easting: **12204685.365sft**
Mapping Angle: **-00° 45' 15"** Combination Scale Factor: **1.000002689**

Monument Type: Existing Berntsen Top Security Rod Monument with a 2-1/2" dia. domed cap and a permanent magnet encased in a 5" dia. PVC pipe with a NGS style aluminum access cover.

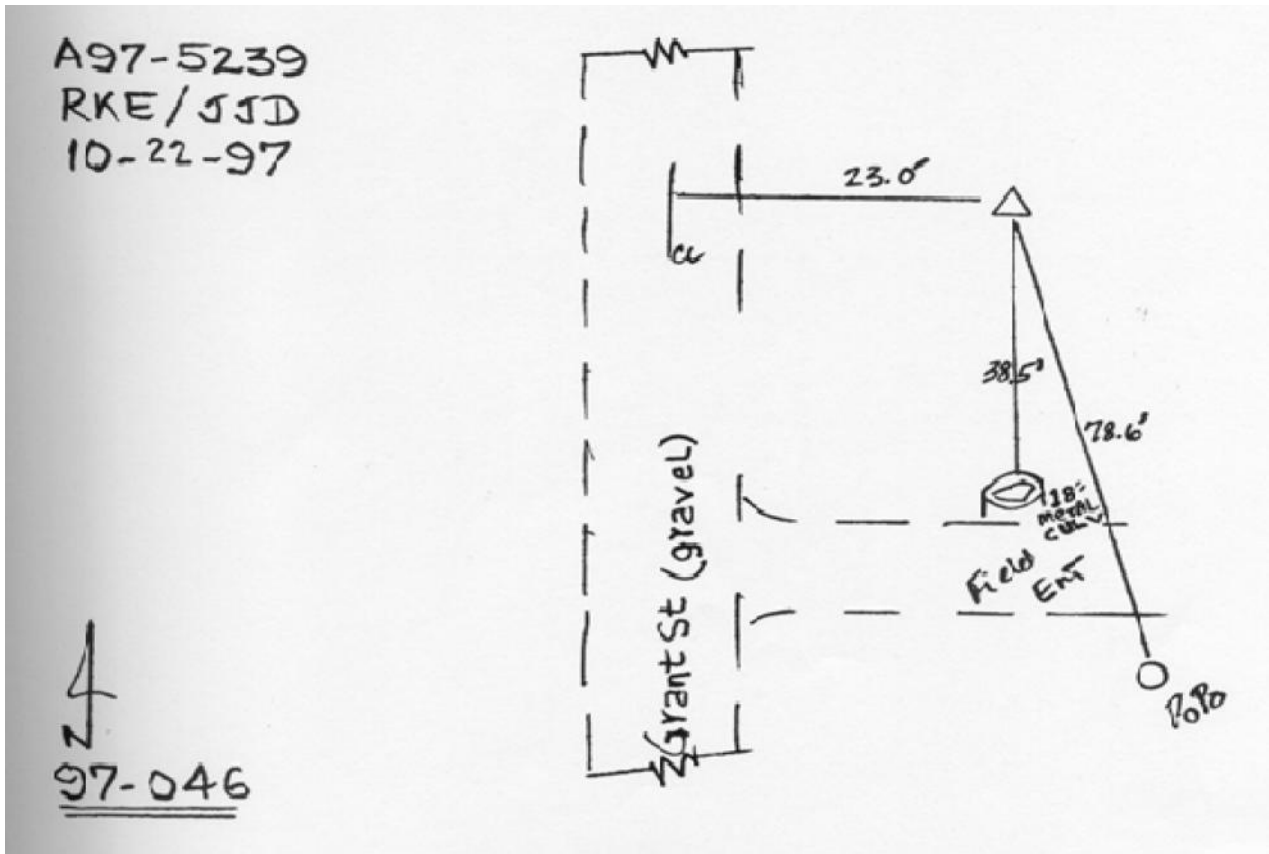

This document was prepared by Dan Corbin, Inc. on April 30, 2015 for Hancock County, Iowa.