

Hancock County, Iowa

Horizontal Datum: **NAD 83(2011)** - Vertical Datum: **NAVD 1988**
Iowa State Plane North Zone (1401)
Iowa Regional Coordinate System, Zone 2. Mason City (LCC)
US Survey Feet
2015

Point Name: **50**

Designation: USGS & STATE SURVEY NO 893

NAD 83(NA2011) Latitude: **N43°13'38.64376"** Longitude: **W93°29'51.08395"**
NAVD 88 Ortho Height: **1270.430sft** Ellip. Ht: **1174.522sft** Geoid12A

Iowa North Zone (1401) Northing: **3910358.778sft** Easting: **4921910.114sft**
Mapping Angle: **0°00'06"** Combination Scale Factor: **0.999937025**

laRCS Zone 2 Northing: **9823027.189sft** Easting: **12300753.848sft**
Mapping Angle: **-00° 30' 41"** Combination Scale Factor: **0.999987320**

Monument Type: Existing concrete post monument with a brass disk set in the top.

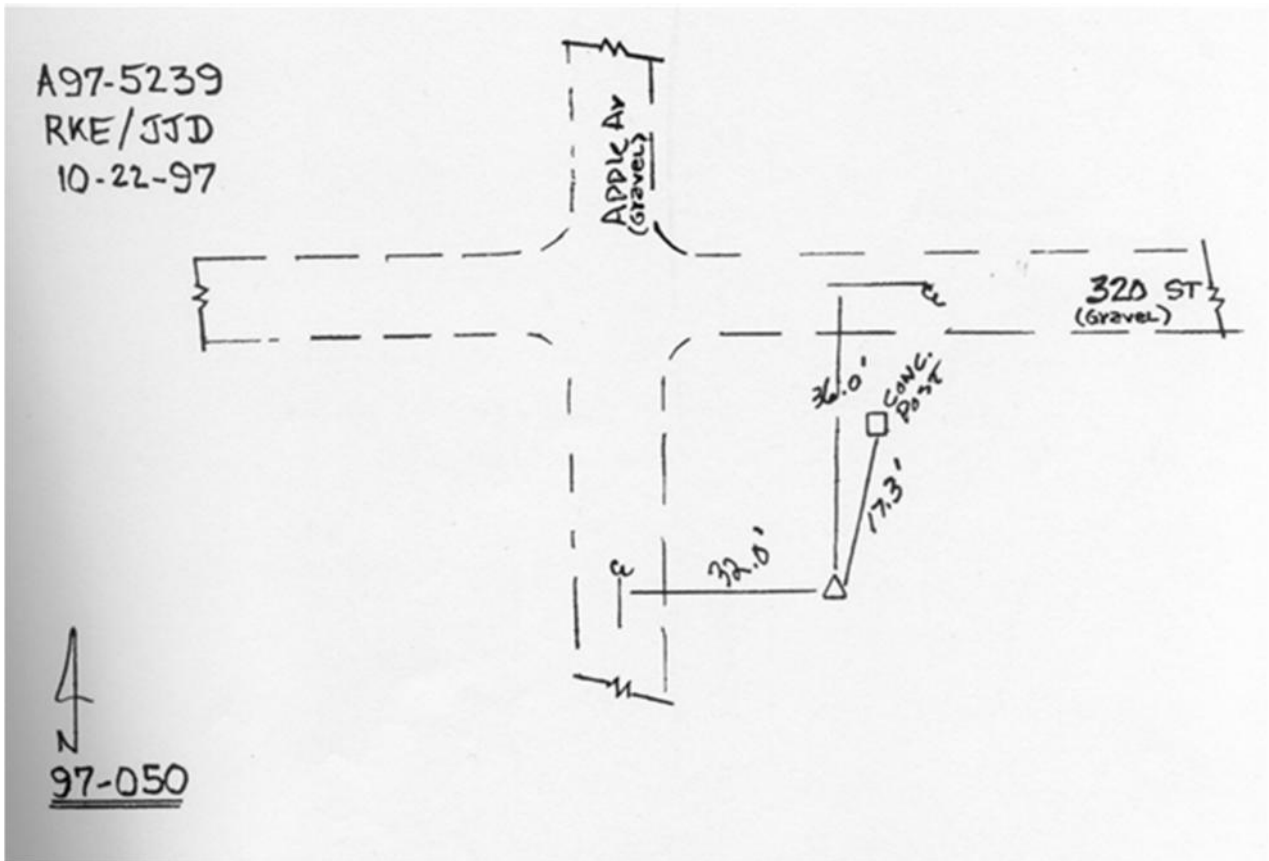

This document was prepared by Dan Corbin, Inc. on April 30, 2015 for Hancock County, Iowa.