

Hancock County, Iowa
Horizontal Datum: **NAD 83(2011)** - Vertical Datum: **NAVD 1988**
Iowa State Plane North Zone (1401)
Iowa Regional Coordinate System, Zone 2. Mason City (LCC)
US Survey Feet
2015

Point Name: **51**

Designation: USGS & STATE SURVEY NO 364

NAD 83(NA2011) Latitude: **N43°08'28.08725"** Longitude: **W93°29'50.60280"**
NAVD 88 Ortho Height: **1262.280sft** Ellip. Ht: **1167.402sft** Geoid12A

Iowa North Zone (1401) Northing: **3878916.360sft** Easting: **4921946.708sft**
Mapping Angle: **0°00'06"** Combination Scale Factor: **0.999923781**

laRCS Zone 2 Northing: **9791583.909sft** Easting: **12300508.867sft**
Mapping Angle: **-00° 30' 41"** Combination Scale Factor: **0.999987199**

Monument Type: Existing concrete post monument with a brass disk set in the top.

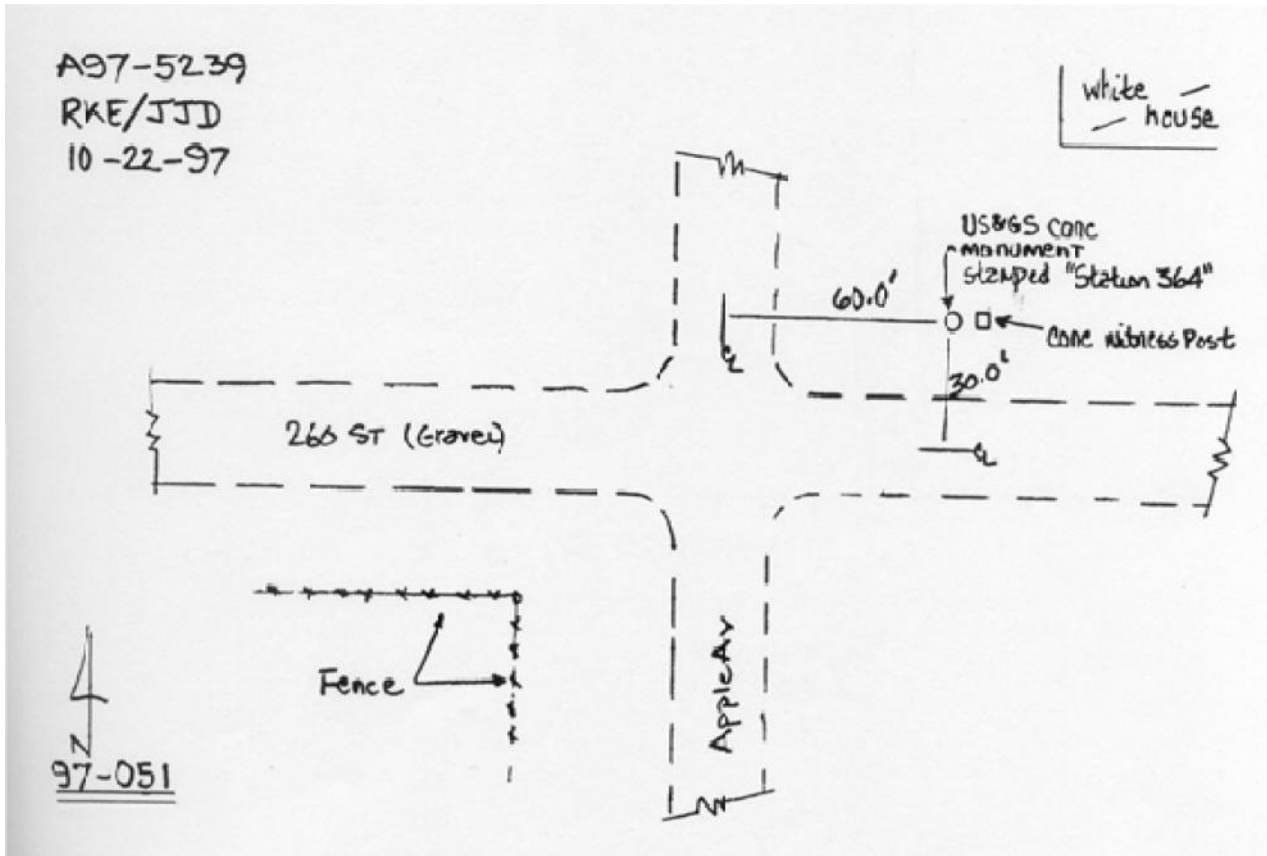

This document was prepared by Dan Corbin, Inc. on April 30, 2015 for Hancock County, Iowa.