

Hancock County, Iowa

Horizontal Datum: **NAD 83(2011)** - Vertical Datum: **NAVD 1988**
Iowa State Plane North Zone (1401)
Iowa Regional Coordinate System, Zone 2. Mason City (LCC)
US Survey Feet
2015

Point Name: **52**

Designation: USGS & STATE SURVEY NO 41-146

NAD 83(NA2011) Latitude: **N43°14'57.23519"** Longitude: **W93°39'53.70534"**
NAVD 88 Ortho Height: **1269.060sft** Ellip. Ht: **1172.139sft** Geoid12A

Iowa North Zone (1401) Northing: **3918358.795sft** Easting: **4877309.619sft**
Mapping Angle: **-0°06'42"** Combination Scale Factor: **0.999940938**

laRCS Zone 2 Northing: **9831427.097sft** Easting: **12256224.683sft**
Mapping Angle: **-00° 37' 33"** Combination Scale Factor: **0.999987909**

Monument Type: Existing concrete post monument with a brass disk set in the top.

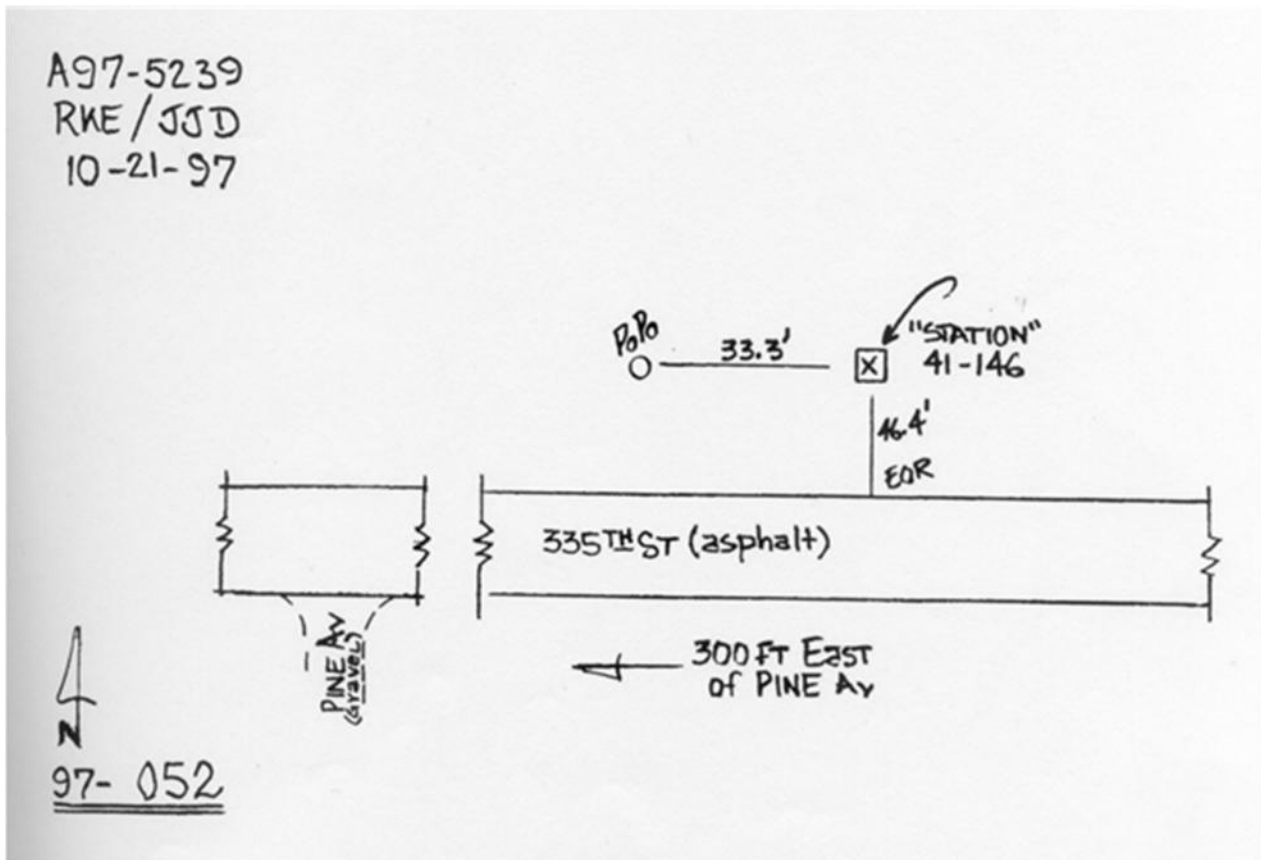

This document was prepared by Dan Corbin, Inc. on April 30, 2015 for Hancock County, Iowa.