

Hancock County, Iowa

Horizontal Datum: **NAD 83(2011)** - Vertical Datum: **NAVD 1988**
Iowa State Plane North Zone (1401)
Iowa Regional Coordinate System, Zone 2. Mason City (LCC)
US Survey Feet
2015

Point Name: **63**

Designation: 2004-063 HANCOCK CO GPS CONTROL PT (Set by DCI in 2004)

NAD 83(NA2011) Latitude: **N43°10'17.76228"** Longitude: **W93°54'39.31127"**
NAVD 88 Ortho Height: **1243.030sft** Ellip. Ht: **1146.806sft** Geoid**12A**

Iowa North Zone (1401) Northing: **3890286.760sft** Easting: **4811628.379sft**
Mapping Angle: **-0°16'43"** Combination Scale Factor: **0.999929301**

laRCS Zone 2 Northing: **9803945.019sft** Easting: **12190290.311sft**
Mapping Angle: **-00° 47' 39"** Combination Scale Factor: **0.999988090**

Monument Type: Berntsen Top Security Rod Monument with a 2-1/2" dia. domed cap and a permanent magnet encased in a 5" dia. PVC pipe with a NGS style aluminum access cover.

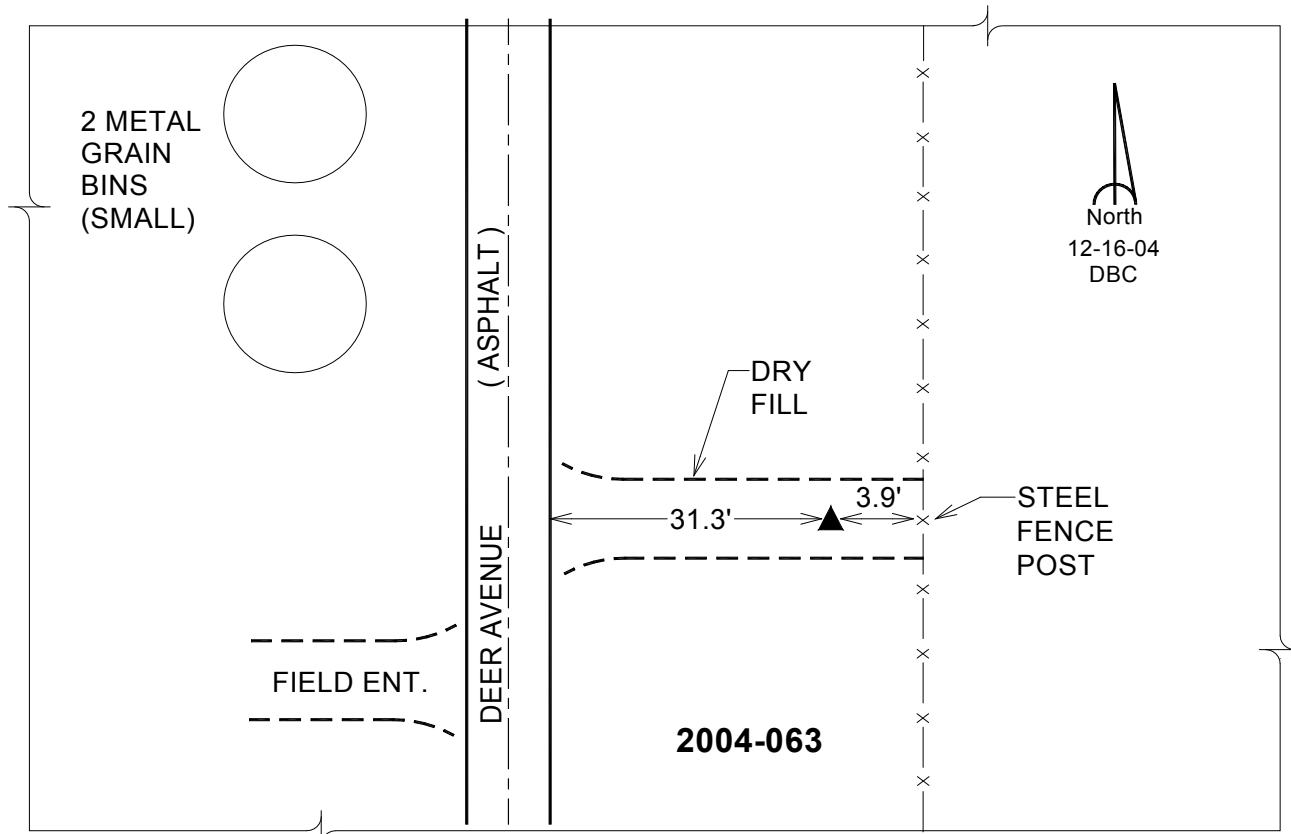

This document was prepared by Dan Corbin, Inc. on April 30, 2015 for Hancock County, Iowa.