

Hardin County, Iowa
 Horizontal Datum: **NAD 83(NA2011)** - Vertical Datum: **NAVD 1988**
 Iowa State Plane North Zone (1401)
 Iowa Regional Coordinate System, Zone 4, Sioux City-Iowa Falls LCC
 US Survey Feet
9/30/18

Point Name: **9785**

Designation: NGS: 1st order Vert. "42 140" PID: NK0284 & IaHARN

NAD 83(NA2011) Latitude: **N42°29'06.37123"** Longitude: **W93°15'45.48261"**
 NAVD 88 Ortho Height: **1127.830sft** Ellip. Ht: **1029.601sft** **Geoid12B**

Iowa North Zone (1401) Northing: **3639916.560sft** Easting: **4985275.080sft**
 Mapping Angle: **0°09'39"** Combination Scale Factor: **0.9999012065**

IaRCS Zone 4 Northing: **8586347.957sft** Easting: **14923683.654sft**
 Mapping Angle: **1°03'43"** Combination Scale Factor: **0.9999961354**

Monument Type: A state survey standard disk, stamped 42-140 and set in the top of a concrete post.

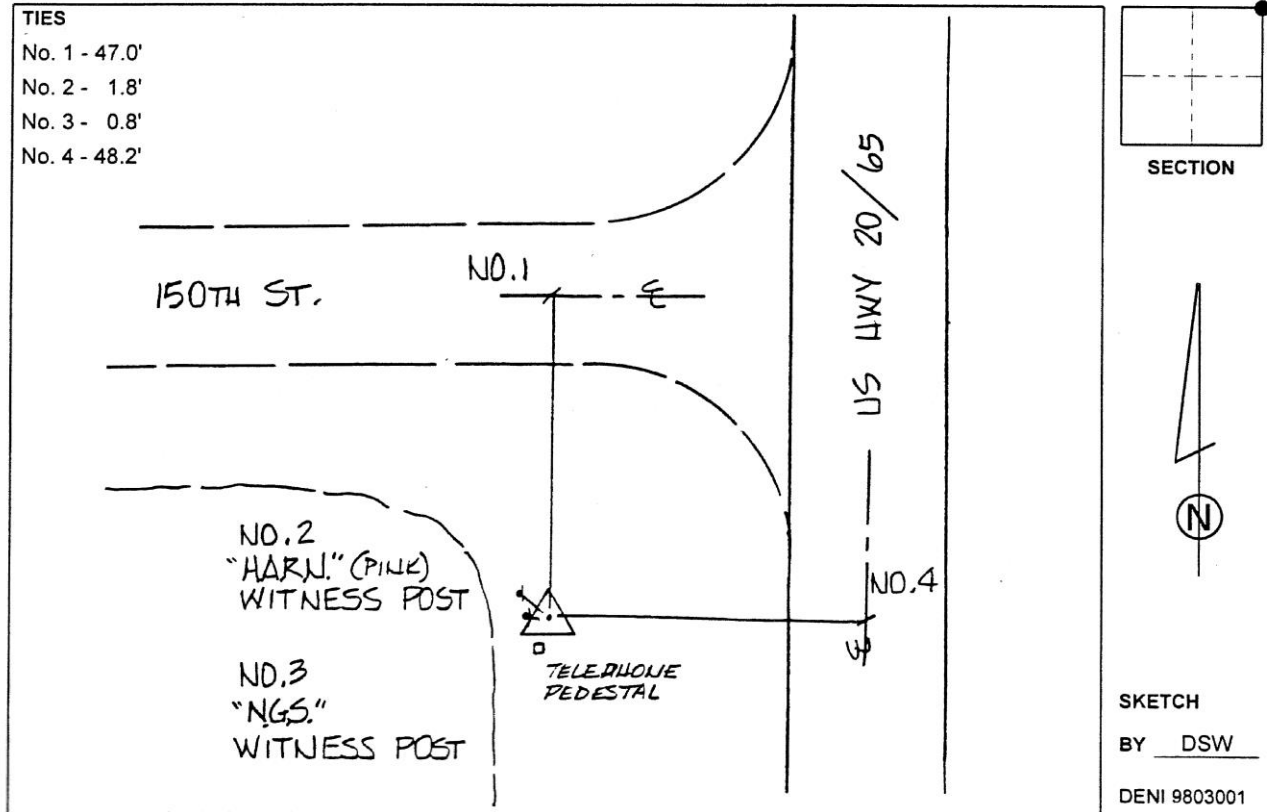

This document was prepared by Dan Corbin, Inc. on February 18th, 2019 for Hardin County, Iowa.