

Reprinted on 10-29-2008
Humboldt County, Iowa
 Iowa North Zone (1401)
 Horiz. Datum: NAD83(1996)
 Vert. Datum: NAVD 1988
 US Survey Feet
 2006

Point Name: 45

Designation: 1997 -045 Hancock County GPS Control Pt. (Set by ASI in 1997)

Northing: 3794260.41sft Easting: 4794949.24sft

Orthometric Height: 1148.23sft Ellipsoid Height: 1052.31sft Geoid03

Latitude: 42°54'28.42211"N

Longitude: 93°58'17.16067"W

Mapping Angle: -0°19'10"

Combination Scale Factor: 0.999903930

Monument Type: Berntsen Top Security Rod Monument with a 2-1/2" dia. domed survey cap and permanent magnet encased in a 5" dia. PVC pipe with a NGS style aluminum access cover.

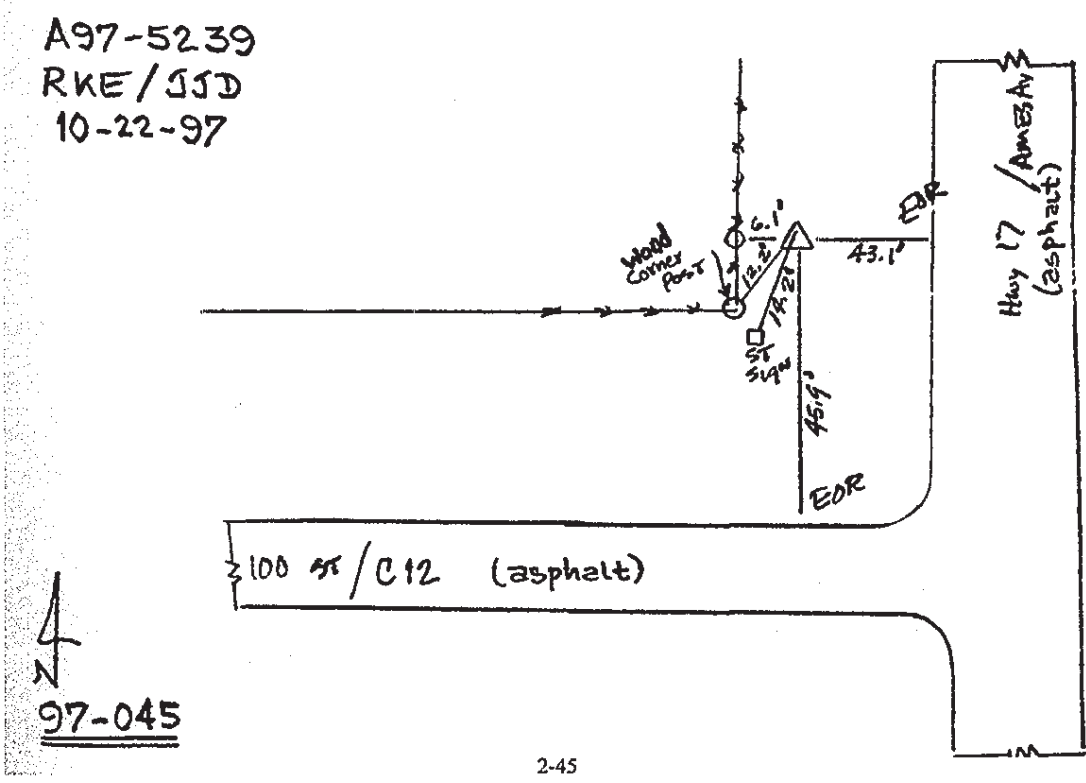

2-45

This document was prepared by DCI and GBC for use by Humboldt County, Iowa