

Reprinted on 10-29-2008
Humboldt County, Iowa
Iowa North Zone (1401)
Horiz. Datum: NAD83(1996)
Vert. Datum: NAVD 1988
US Survey Feet
2006

Point Name: **607**

Designation: 2005-607 Kossuth Co GPS Control Pt (set by DCI in 2005)

Northing: **3795064.04sft** Easting: **4700274.30sft**

Orthometric Height: **1136.14sft** Ellipsoid Height: **1040.80sft** **Geoid03**

Latitude: **42°54'29.19032"N**

Longitude: **94°19'29.39276"W**

Mapping Angle: **-0°33'32"**

Combination Scale Factor: **0.999904500**

Monument Type: Berntsen Top Security Rod Monument with a 2-1/2" dia. domed survey cap and permanent magnet encased in a 5" dia. PVC pipe with a NGS style aluminum access cover.

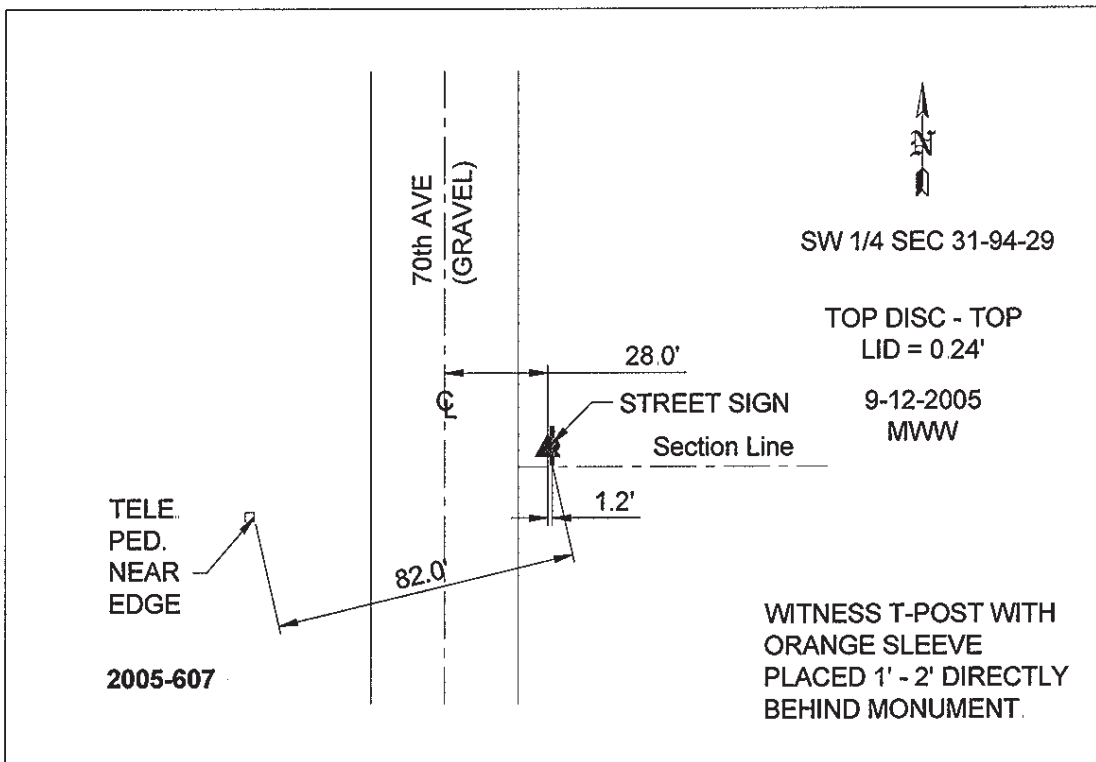

This document was prepared by DCI and GBC for use by Humboldt County, Iowa