

Reprinted on 10-29-2008
Humboldt County, Iowa
Iowa North Zone (1401)
Horiz. Datum: NAD83(1996)
Vert. Datum: NAVD 1988
US Survey Feet
2006

Point Name: 610

Designation: 2005-610 Kossuth Co GPS Control Pt (set by DCI in 2005)

Northing: 3794664.17sft Easting: 4747968.11sft

Orthometric Height: 1145.82sft Ellipsoid Height: 1049.74sft Geoid03

Latitude: 42°54'29.34106"N Longitude: 94°08'48.48767"W

Mapping Angle: -0°26'18" Combination Scale Factor: 0.999904070

Monument Type: Berntsen Top Security Rod Monument with a 2-1/2" dia. domed survey cap and permanent magnet encased in a 5" dia. PVC pipe with a NGS style aluminum access cover.

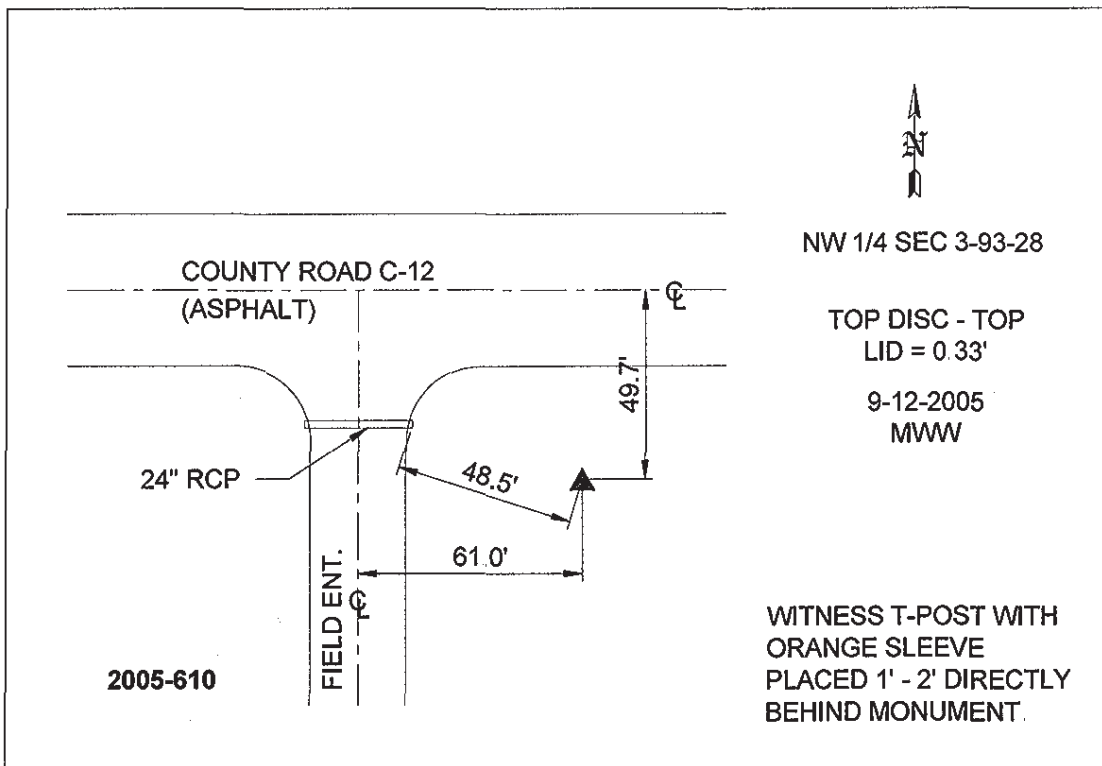

This document was prepared by DCI and GBC for use by Humboldt County, Iowa.