

2000  
Iowa County, Iowa  
Iowa South Zone (1402)  
NAD\_83(1996)

Point Number: 212

Northing: 618629.95(Ft)      Easting: 2062522.90(Ft)

Northing: 188558.787(M)      Easting: 628658.237(M)

Elev: 850.20(Ft) NAVD\_88

Elev: 259.141(M) NAVD\_88      Ellip Ht: 226.955(M)      96C Geoid Ht: -32.186(M)

Latitude: 41-41-15.542727 N      Longitude: 91-57-16.334744 W

Theta: 1-01-04.79      Combination Factor: 0.99994880

Designation: 99-212 IOWA CO GPS CONTROL PT

**Monument Type:** 5/8" dia driven aluminum rod with a 2-1/2" dia aluminum cap and permanent magnet encased in a 5" dia PVC pipe with an aluminum access cover.

**To Reach:** 55ft N of 220th Ave, 1/4 Mile W of "S" Ave. Approx 1/4 Mile W of the SE Corner of Sec 36, T80N, R10W.

Date Printed March 22, 2000

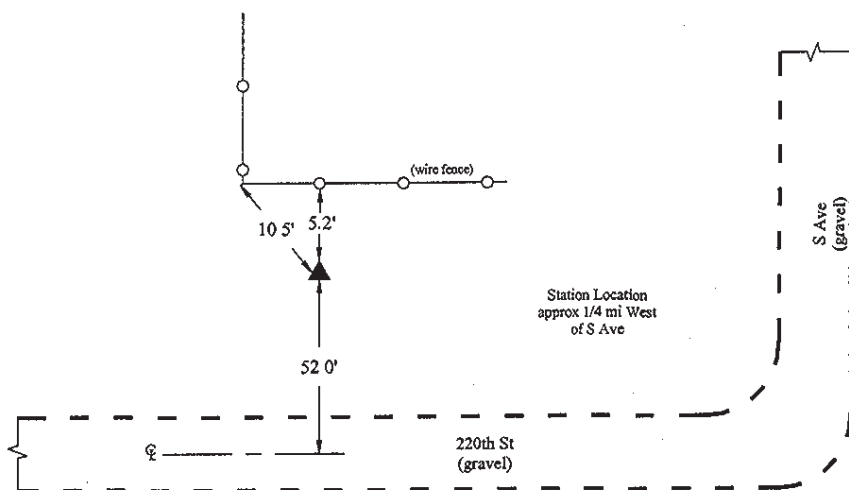

99-212  
BRS/RKE

Quad Name: Conroy

Set NGS style rod  
monument with  
access cover