

2000  
Iowa County, Iowa  
Iowa South Zone (1402)  
NAD\_83(1996)

Point Number: 217

Northing: 552493.61(Ft)      Easting: 1969782.93(Ft)

Northing: 168400.390(M)      Easting: 600391.039(M)

Elev: 904.74(Ft) NAVD\_88

Elev: 275.761(M) NAVD\_88      Ellip Ht: 243.666(M)      96C Geoid Ht: -32.095(M)

Latitude: 41-30-36.678217 N      Longitude: 92-17-50.587919 W

Theta: 0-47-31.79      Combination Factor: 0.99992467

Designation: 99-217 IOWA CO GPS CONTROL PT

**Monument Type:** 5/8" dia driven aluminum rod with a 2-1/2" dia aluminum cap and permanent magnet encased in a 5" dia PVC pipe with an aluminum access cover.

**To Reach:** 30ft W of Poweshiek/Iowa Rd and 150ft N of Keokuk/Iowa Rd. Near the SW Corner of Sec 31, T78N, R12W.

Date Printed March 22, 2000

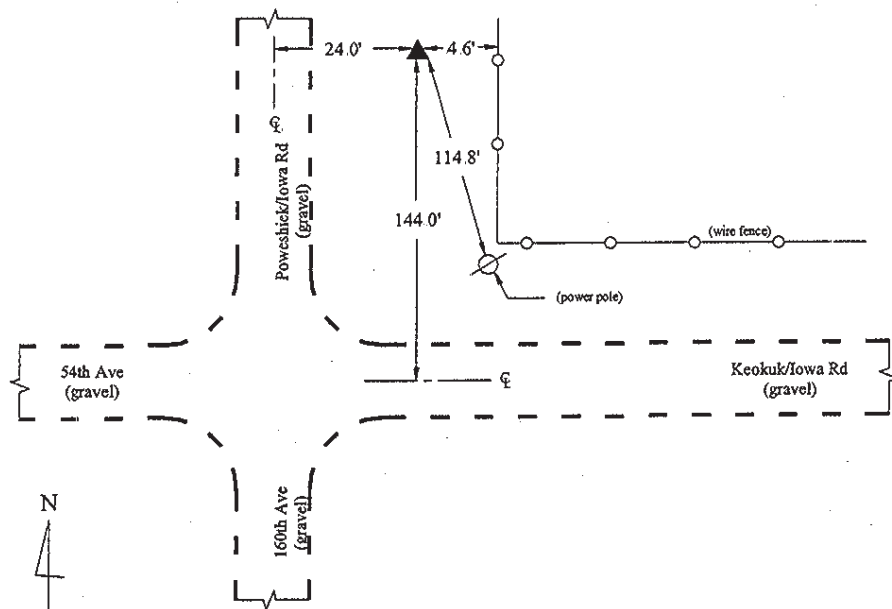

99-217  
BRS/RKE

Quad Name: Deep River

Set NGS style rod  
monument with  
access cover