

Iowa County, Iowa  
Iowa South Zone (1402)  
Horiz. Datum: NAD83(NSRS2007)  
Vert. Datum: NAVD 1988  
US Survey Feet  
**2008**

Point Name: **4211**

**Designation:** 99-211 Iowa Co GPS Control Pt (Set by ASI in 1999)

Northing: **617307.76sft** Easting: **2032129.59sft**

Orthometric Height: **855.28sft** Ellipsoid Height: **749.59sft** **Geoid03**

Latitude: **41°41'07.62456"N** Longitude: **92°03'57.15241"W**

Mapping Angle: **0°56'41"** Combination Scale Factor: **0.99994832**

**Monument Type:** 5/8" dia. driven aluminum rod with a 2-1/2" dia. aluminum cap and permanent magnet encased in a 6" dia. PVC pipe with an aluminum access cover.

**To Reach:** 90ft E of "M" Ave approx 800ft S of I80. Approx 400ft S of NW Corner of Sec 6, T79N, R10W.

Date Printed March 22, 2000

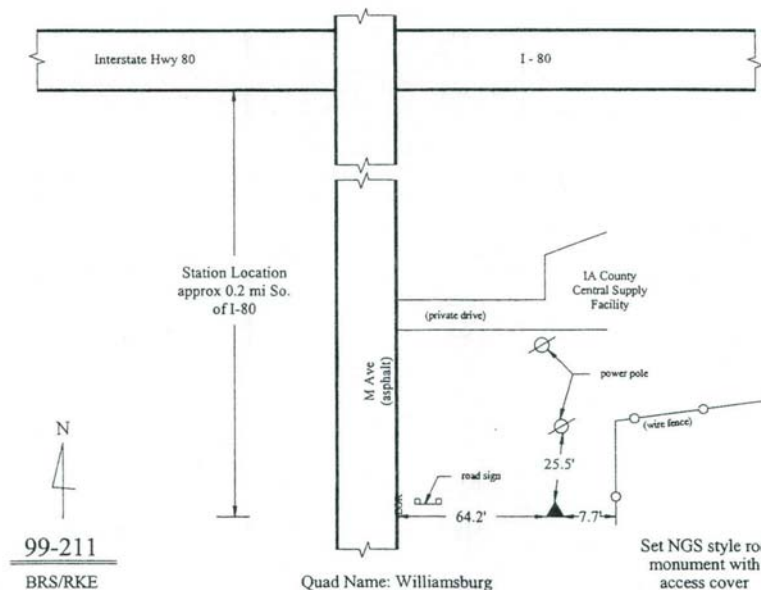

*This document was prepared by DCI and GBC for use by Iowa County, Iowa.*