

Iowa County, Iowa
Iowa South Zone (1402)
Horiz. Datum: NAD83(NSRS2007)
Vert. Datum: NAVD 1988
US Survey Feet
2008

Point Name: **4222**

Designation: 99-222 Iowa Co GPS Control Pt (Set by ASI in 1999)

Northing: **580192.81**sft Easting: **2049767.16**sft

Orthometric Height: **859.97**sft Ellipsoid Height: **753.65**sft **Geoid03**

Latitude: **41°34'58.05455"N** Longitude: **92°00'13.14543"W**

Mapping Angle: **0°59'08"** Combination Scale Factor: **0.99993458**

Monument Type: 5/8" dia. driven aluminum rod with a 2-1/2" dia. aluminum cap and permanent magnet encased in a 6" dia. PVC pipe with an aluminum access cover.

To Reach: Set in the center of Parnell City Park near the NW Corner of Sec 10 T78N R10W.

Date Printed March 22, 2000

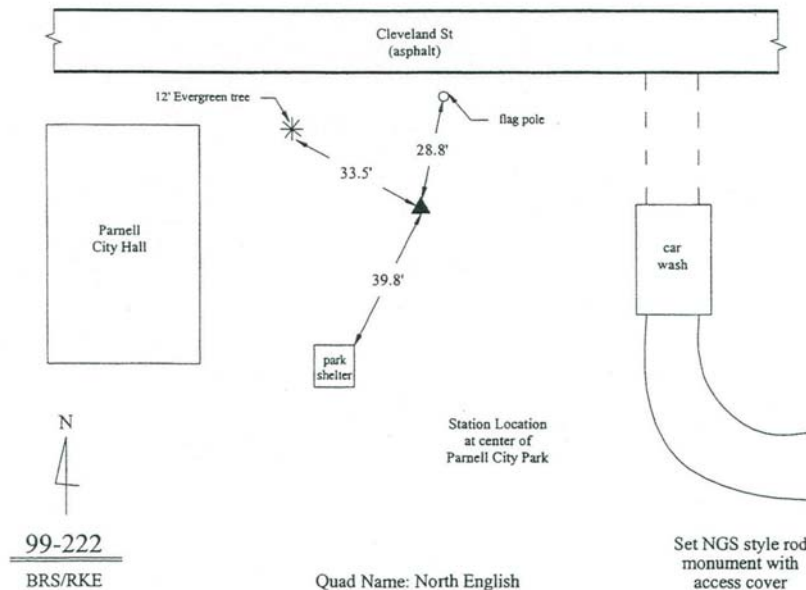

This document was prepared by DCI and GBC for use by Iowa County, Iowa.