

Iowa County, Iowa
Iowa South Zone (1402)
Horiz. Datum: NAD83(NSRS2007)
Vert. Datum: NAVD 1988
US Survey Feet
2008

Point Name: **3219**

Designation: 99-219 Iowa Co GPS Control Pt (Set by ASI in 1999)

Northing: **553571.71**sft Easting: **2034168.42**sft

Orthometric Height: **833.44**sft Ellipsoid Height: **727.14**sft **Geoid03**

Latitude: **41°30'37.67421"N** Longitude: **92°03'44.16901"W**

Mapping Angle: **0°56'49"** Combination Scale Factor: **0.99992824**

Monument Type: 5/8" dia. driven aluminum rod with a 2-1/2" dia. aluminum cap and permanent magnet encased in a 6" dia. PVC pipe with an aluminum access cover.

To Reach: 30ft N of Keokuk/Iowa Road and approx 600ft E of "M" Ave. Approx 600 ft E of the SW Corner of Sec 31, T78N, R10W.

Date Printed March 22, 2000

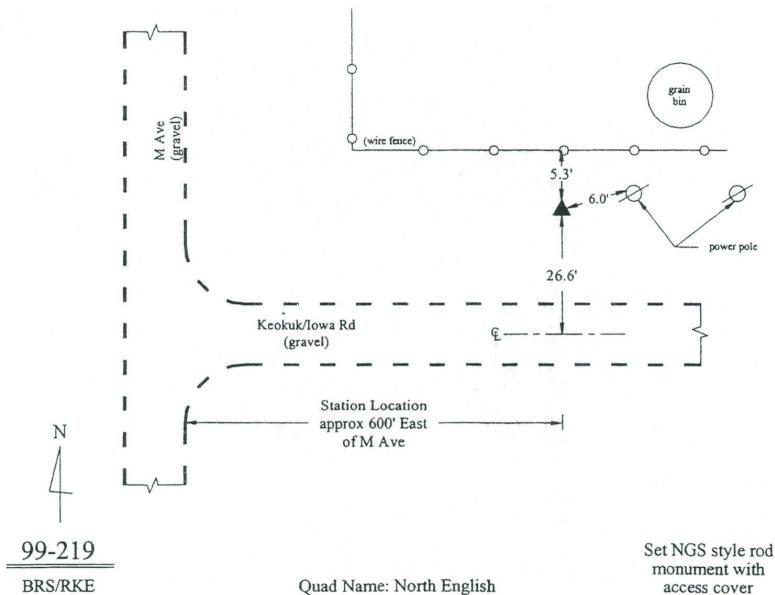

This document was prepared by DCI and GBC for use by Iowa County, Iowa.