

Iowa County, Iowa
Iowa South Zone (1402)
Horiz. Datum: NAD83(NSRS2007)
Vert. Datum: NAVD 1988
US Survey Feet
2008

Point Name: **4087**

Designation: 2003-087 Benton Co GPS Control Pt (Set by DCI in 2003)

Northing: **679485.91**sft Easting: **1973336.91**sft

Orthometric Height: **775.75**sft Ellipsoid Height: **671.44**sft **Geoid03**

Latitude: **41°51'30.69901"N** Longitude: **92°16'40.42652"W**

Mapping Angle: **0°48'18"** Combination Scale Factor: **0.99998218**

Monument Type: 5/8" dia. driven aluminum rod with a 2-1/2" dia. aluminum cap and permanent magnet encased in a 5" dia. PVC pipe with an aluminum access cover.

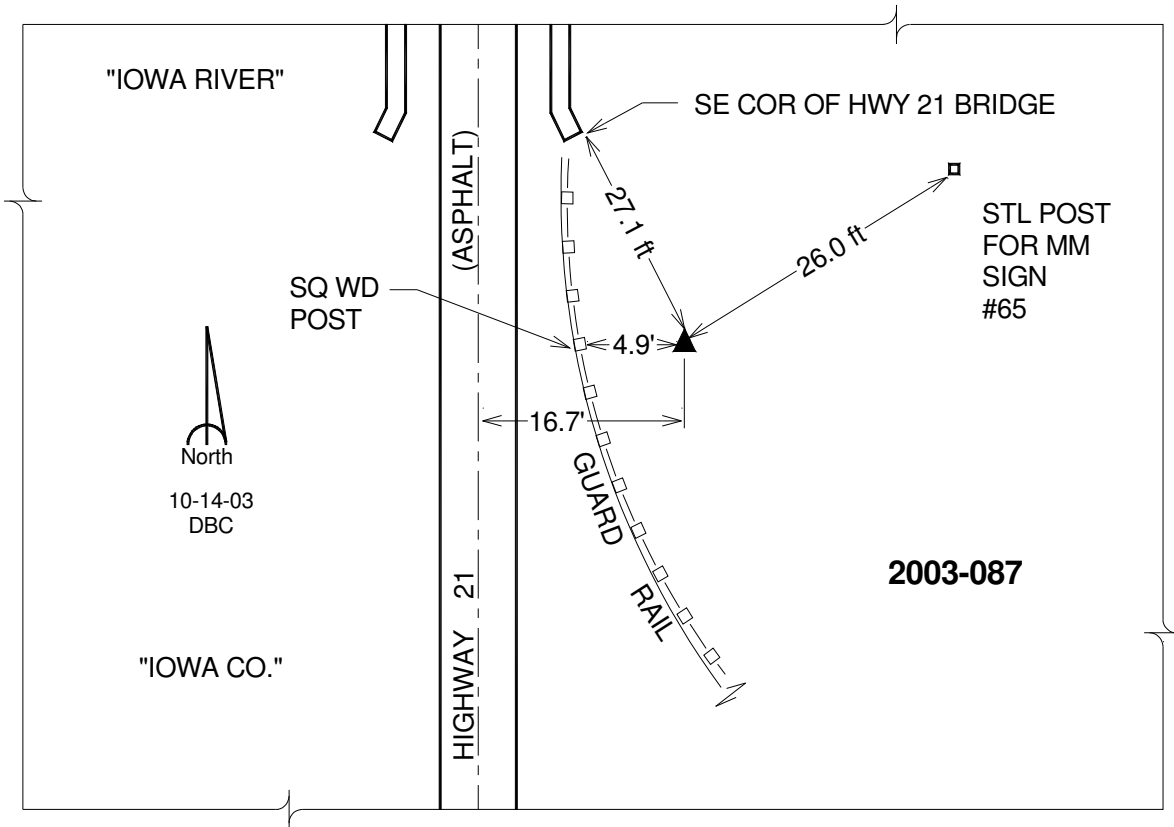

This document was prepared by DCI and GBC for use by Iowa County, Iowa.