

Iowa County, Iowa  
Iowa South Zone (1402)  
Horiz. Datum: NAD83(NSRS2007)  
Vert. Datum: NAVD 1988  
US Survey Feet  
**2008**

Point Name: **4222**

**Designation:** 99-222 Iowa Co GPS Control Pt (Set by ASI in 1999)

Northing: **580192.81**sft Easting: **2049767.16**sft

Orthometric Height: **859.97**sft Ellipsoid Height: **753.65**sft **Geoid03**

Latitude: **41°34'58.05455"N** Longitude: **92°00'13.14543"W**

Mapping Angle: **0°59'08"** Combination Scale Factor: **0.99993458**

**Monument Type:** 5/8" dia. driven aluminum rod with a 2-1/2" dia. aluminum cap and permanent magnet encased in a 6" dia. PVC pipe with an aluminum access cover.

**To Reach:** Set in the center of Parnell City Park near the NW Corner of Sec 10 T78N R10W.

Date Printed March 22, 2000

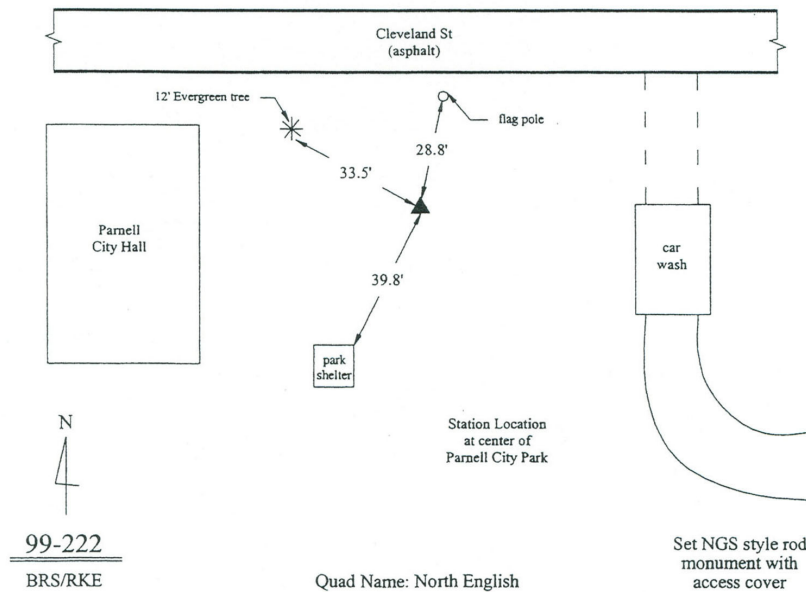

*This document was prepared by DCI and GBC for use by Iowa County, Iowa.*