

Jasper County, Iowa
 Iowa South Zone (1402)
 Horiz. Datum: NAD83(1996)
 Vert. Datum: NAVD 1988
 US Survey Feet
2005

Point Name: **G04**

Designation: Jasper County GPS Monument G04-2005

Northing: **631207.61sft** Easting: **1742559.22sft**

Orthometric Height: **830.19sft** Ellipsoid Height: **725.82sft** **Geoid03**

Latitude: **41°43'54.68125"** Longitude: **93°07'32.84061"**

Mapping Angle: **0°14'47"** Combination Scale Factor: **0.99995663**

Monument Type: Cast in-place concrete monument with aluminum disk.

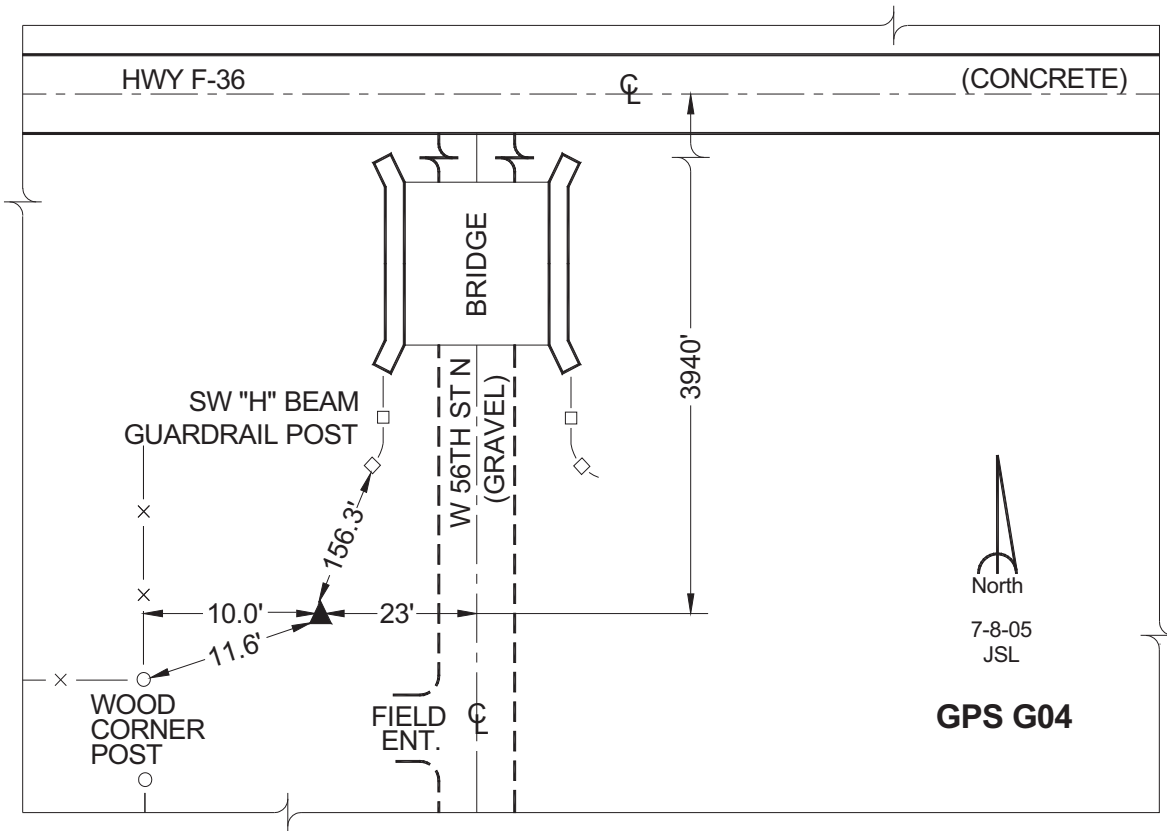

This document was prepared by GBC and DCI for use by Jasper County, Iowa.