

Jasper County, Iowa
Iowa South Zone (1402)
Horiz. Datum: NAD83(1996)
Vert. Datum: NAVD 1988
US Survey Feet
2005

Point Name: **K04**

Designation: Jasper County GPS Monument K04-2005

Northing: **601789.89sft** Easting: **1825041.68sft**

Orthometric Height: **820.56sft** Ellipsoid Height: **715.39sft** **Geoid03**

Latitude: **41°38'59.13398"** Longitude: **92°49'28.02577"**

Mapping Angle: **0°26'42"** Combination Scale Factor: **0.99994488**

Monument Type: Cast in-place concrete monument with aluminum disk.

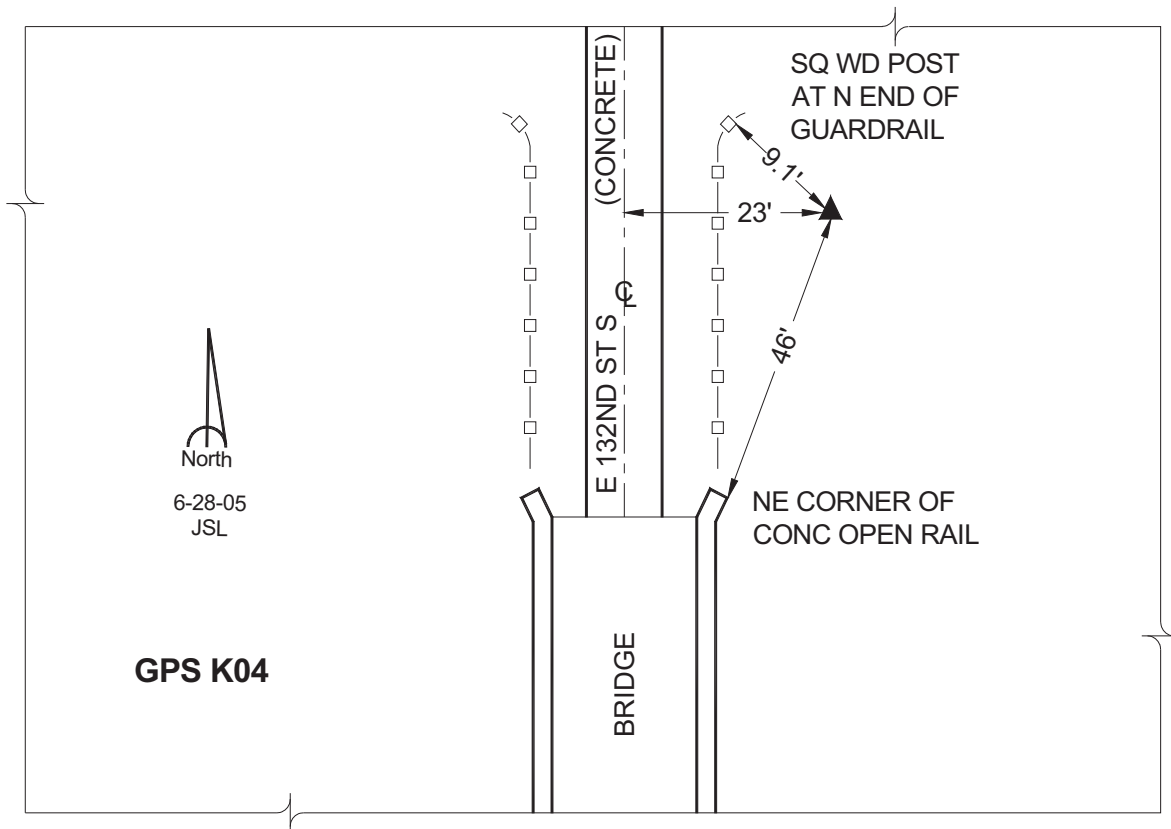

This document was prepared by GBC and DCI for use by Jasper County, Iowa.