

Jasper County, Iowa
Iowa South Zone (1402)
Horiz. Datum: NAD83(1996)
Vert. Datum: NAVD 1988
US Survey Feet
2005

Point Name: **M01**

Designation: Jasper County GPS Monument M01-2005

Northing: **613620.78sft** Easting: **1761084.44sft**

Orthometric Height: **947.48sft** Ellipsoid Height: **842.83sft** **Geoid03**

Latitude: **41°41'00.07503"** Longitude: **93°03'29.69318"**

Mapping Angle: **0°17'28"** Combination Scale Factor: **0.99994356**

Monument Type: Cast in-place concrete monument with aluminum disk.

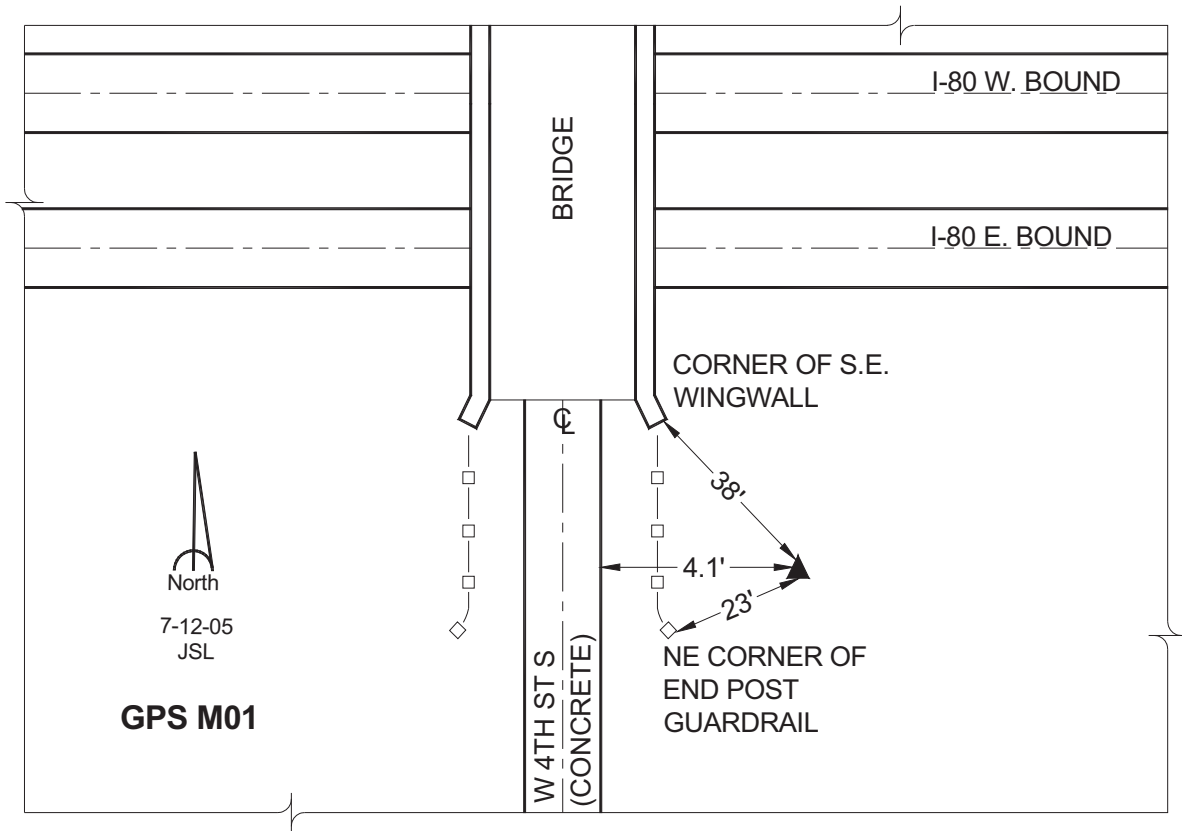

This document was prepared by GBC and DCI for use by Jasper County, Iowa.