

Jefferson County, Iowa
Iowa South Zone (1402)
Horiz. Datum: NAD83(1996)
Vert. Datum: NAVD 1988
US Survey Feet
2005

Point Name: **138**

Designation: 2000-138 Van Buren Co GPS Control Pt. (Set by ASI in 2000)

Northing: **331543.81sft** Easting: **2053226.84sft**

Orthometric Height: **756.88sft** Ellipsoid Height: **648.98sft** **Geoid03**

Latitude: **40°54'01.01359"N**

Longitude: **92°00'23.79901"W**

Mapping Angle: **0°59'01"**

Combination Scale Factor: **0.99993109**

Monument Type: 5/8" diameter driven aluminum rod with 2 1/2" diameter aluminum survey cap and permanent magnet, encased in 5" dia. PVC pipe with an aluminum access cover.

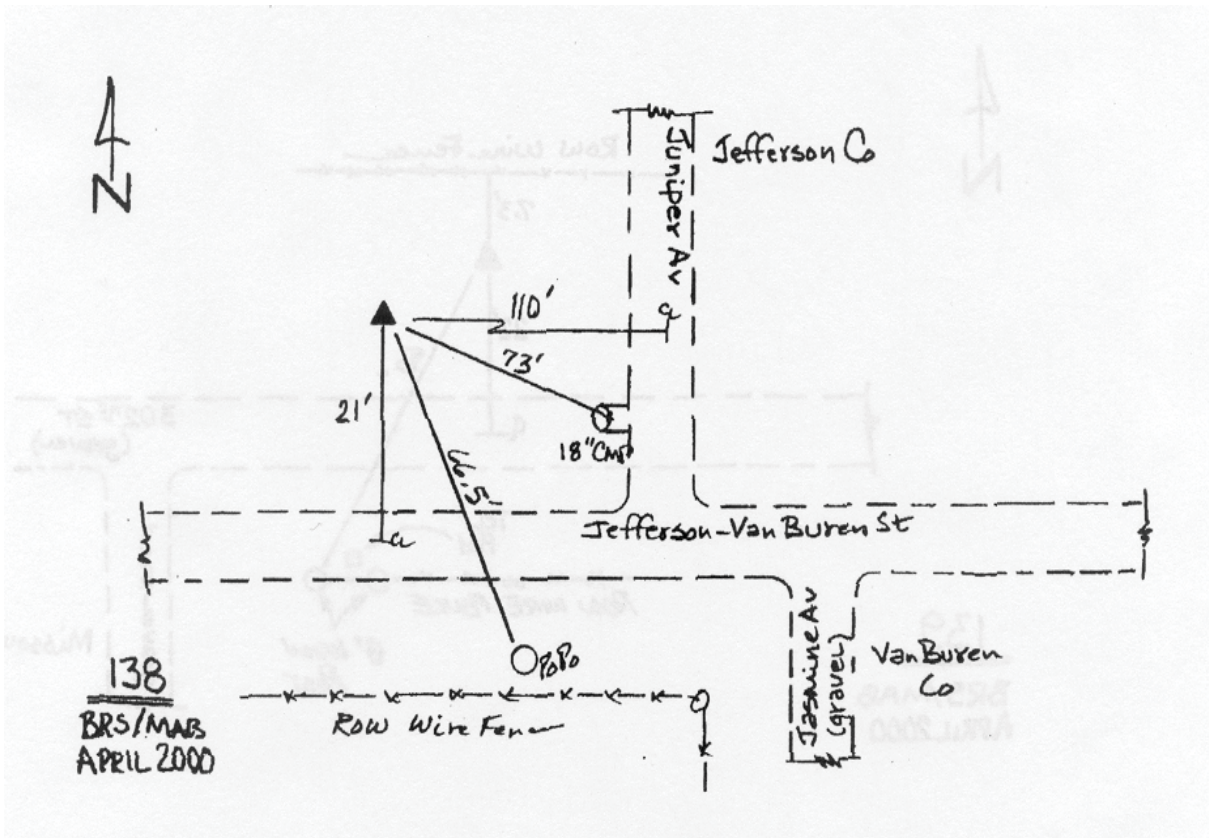

This document was prepared by DCI for use by Jefferson Co., Iowa.