

Jefferson County, Iowa  
Iowa South Zone (1402)  
Horiz. Datum: NAD83(1996)  
Vert. Datum: NAVD 1988  
US Survey Feet  
2005

Point Name: 143

**Designation:** 2000-143 Van Buren Co GPS Control Pt. (Set by ASI in 2000)

Northing: 331973.77sft Easting: 2069239.12sft

Orthometric Height: 755.92sft Ellipsoid Height: 647.93sft Geoid03

Latitude: 40°54'02.49246"N Longitude: 91°56'55.20787"W

Mapping Angle: 1°01'19" Combination Scale Factor: 0.99993110

**Monument Type:** 5/8" diameter driven aluminum rod with 2 1/2" diameter aluminum survey cap and permanent magnet, encased in 5" dia. PVC pipe with an aluminum access cover.

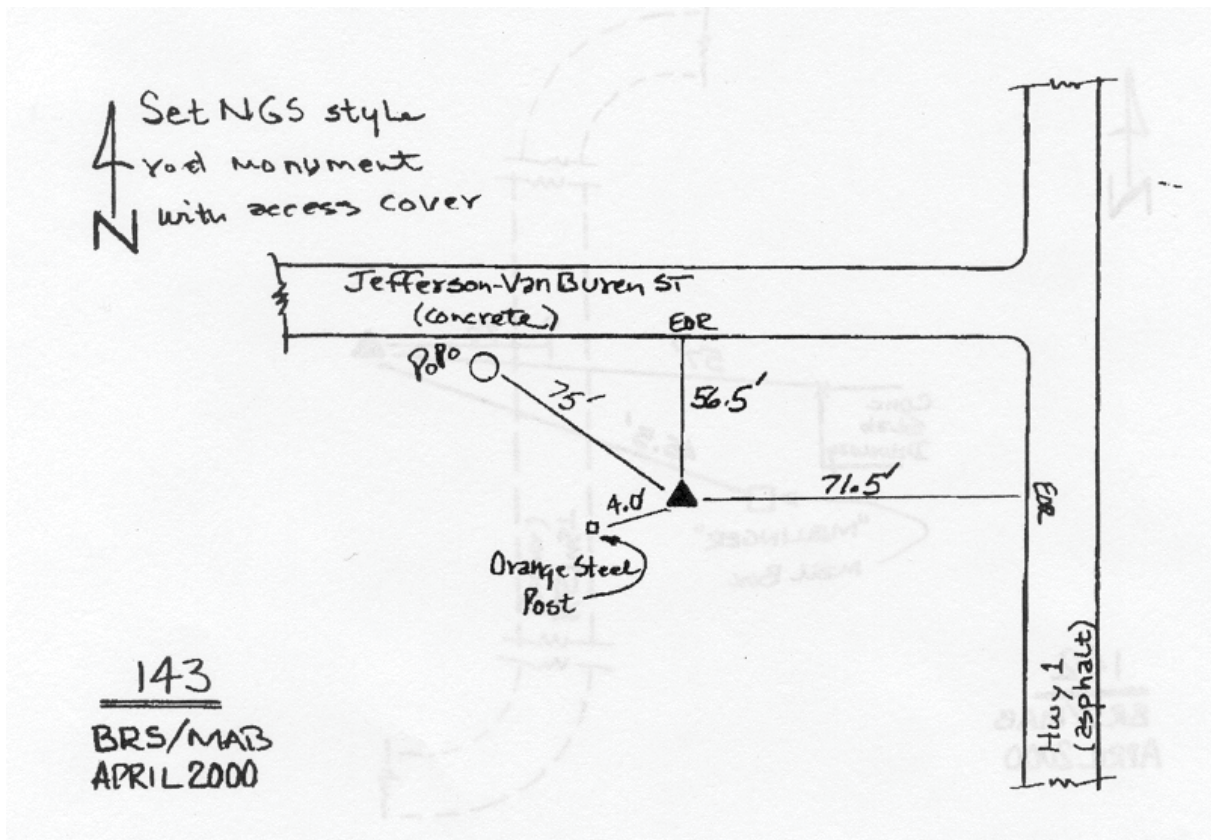

This document was prepared by DCI for use by Jefferson Co., Iowa.