

**Jefferson County, Iowa**  
Iowa South Zone (1402)  
Horiz. Datum: NAD83(1996)  
Vert. Datum: NAVD 1988  
US Survey Feet  
**2005**

Point Name: **164**

**Designation:** 96-164 Washington Co GPS Control Pt. (Set by ASI in 1996)

Northing: **429061.79sft** Easting: **2132889.75sft**

Orthometric Height: **654.76sft** Ellipsoid Height: **547.00sft** **Geoid03**

Latitude: **41°09'49.57159"N**

Longitude: **91°42'40.46951"W**

Mapping Angle: **1°10'42"**

Combination Scale Factor: **0.99992248**

**Monument Type:** 5/8" diameter driven aluminum rod with 2 1/2" diameter aluminum survey cap and permanent magnet, encased in 5" dia. PVC pipe with an aluminum access cover.

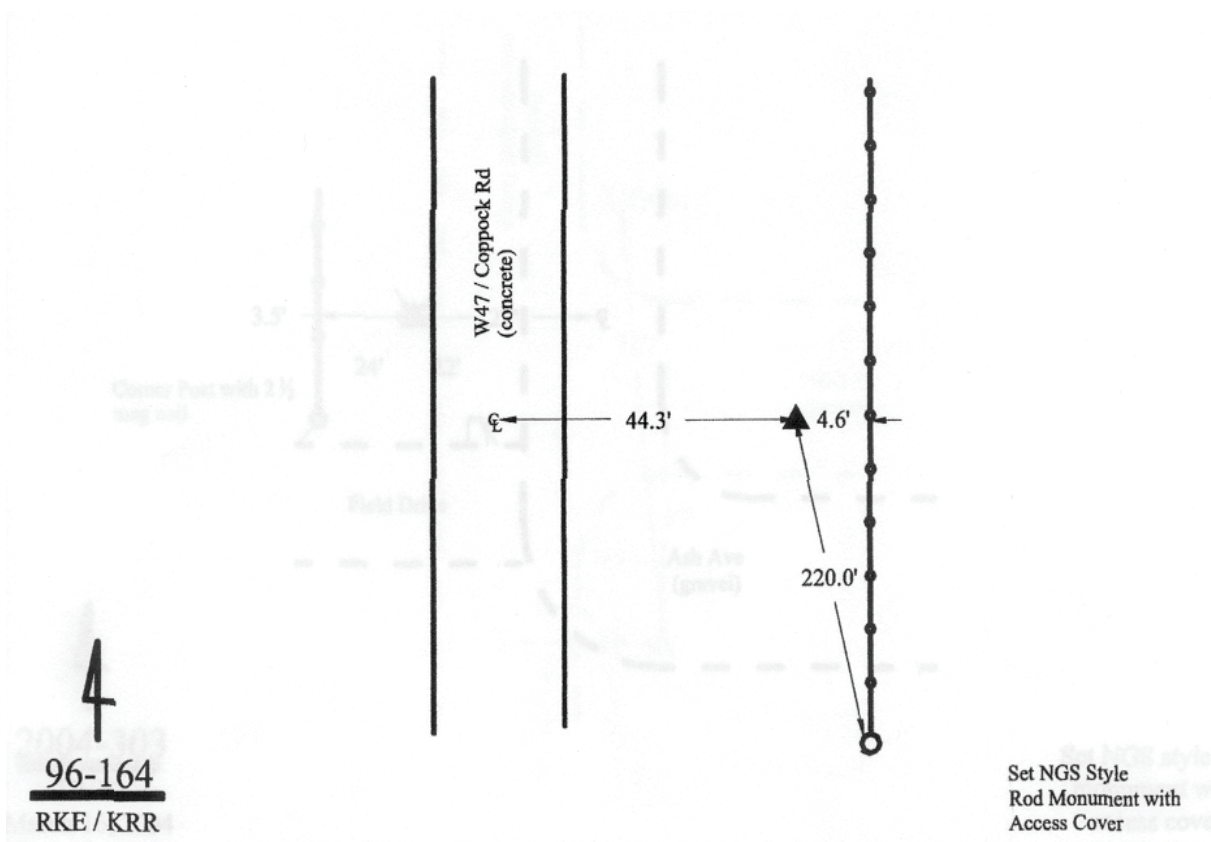

*This document was prepared by DCI for use by Jefferson Co., Iowa.*