

Jefferson County, Iowa
Iowa South Zone (1402)
Horiz. Datum: NAD83(1996)
Vert. Datum: NAVD 1988
US Survey Feet
2005

Point Name: **316**

Designation: 2004-316 Henry Co GPS Control Pt. (Set by ASI in 2004)

Northing: **378466.88sft** Easting: **2132017.23sft**

Orthometric Height: **687.55sft** Ellipsoid Height: **579.60sft** **Geoid03**

Latitude: **41°01'29.92779"N** Longitude: **91°43'05.42559"W**

Mapping Angle: **1°10'25"** Combination Scale Factor: **0.99992540**

Monument Type: 5/8" diameter driven aluminum rod with 2 1/2" diameter aluminum survey cap and permanent magnet, encased in 5" dia. PVC pipe with an aluminum access cover.

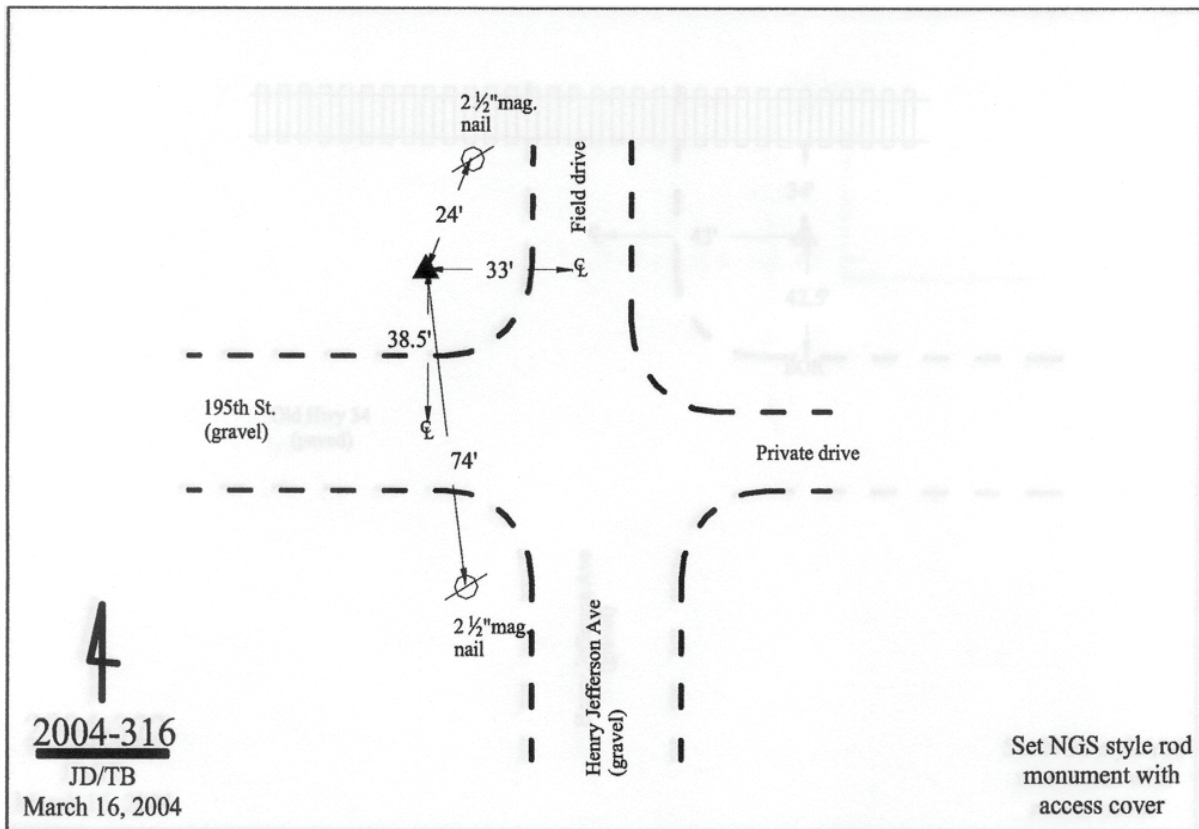

This document was prepared by DCI for use by Jefferson Co., Iowa.