

Jefferson County, Iowa  
Iowa South Zone (1402)  
Horiz. Datum: NAD83(1996)  
Vert. Datum: NAVD 1988  
US Survey Feet  
2005

Point Name: 62

**Designation:** 93-62 Wapello Co GPS Control Pt. (Set by ASI in 1993)

Northing: 346415.05sft Easting: 2005265.51sft

Orthometric Height: 771.06sft Ellipsoid Height: 663.43sft Geoid03

Latitude: 40°56'35.60531"N Longitude: 92°10'45.37691"W

Mapping Angle: 0°52'12" Combination Scale Factor: 0.99992677

**Monument Type:** 5/8" diameter driven aluminum rod with 2 1/2" diameter aluminum survey cap and permanent magnet, encased in 5" dia. PVC pipe with aluminum access cover. Approx. 6" below the ground surface.

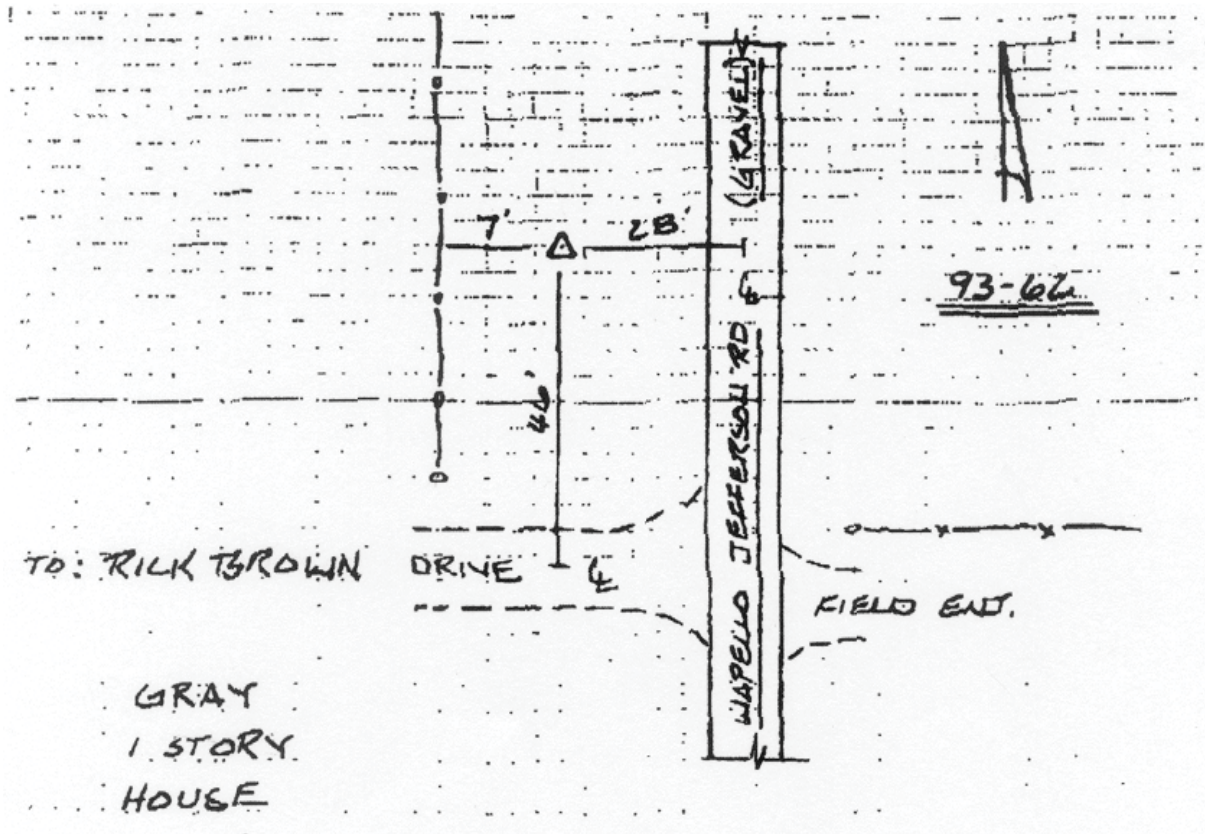

This document was prepared by DCI for use by Jefferson Co., Iowa.