

Johnson County, Iowa
Iowa South Zone (1402)
Horiz. Datum: NAD83(1996)
Vert. Datum: NAVD 1988
US Survey Feet
2006

Point Name: **42**

Designation: 92-42 Johnson County GPS Control Point (Set by ASI in 1992)

Northing: **609410.06sft** Easting: **2159533.73sft**

Orthometric Height: **769.75sft** Ellipsoid Height: **662.87sft** **Geoid03**

Latitude: **41°39'25.49124"N** Longitude: **91°36'00.68453"W**

Mapping Angle: **1°15'05"** Combination Scale Factor: **0.99994839**

Monument Type: 5/8" dia. driven aluminum rod with a 2-1/2" dia. aluminum cap and permanent magnet encased in a 6" dia. PVC pipe with an aluminum access cover.

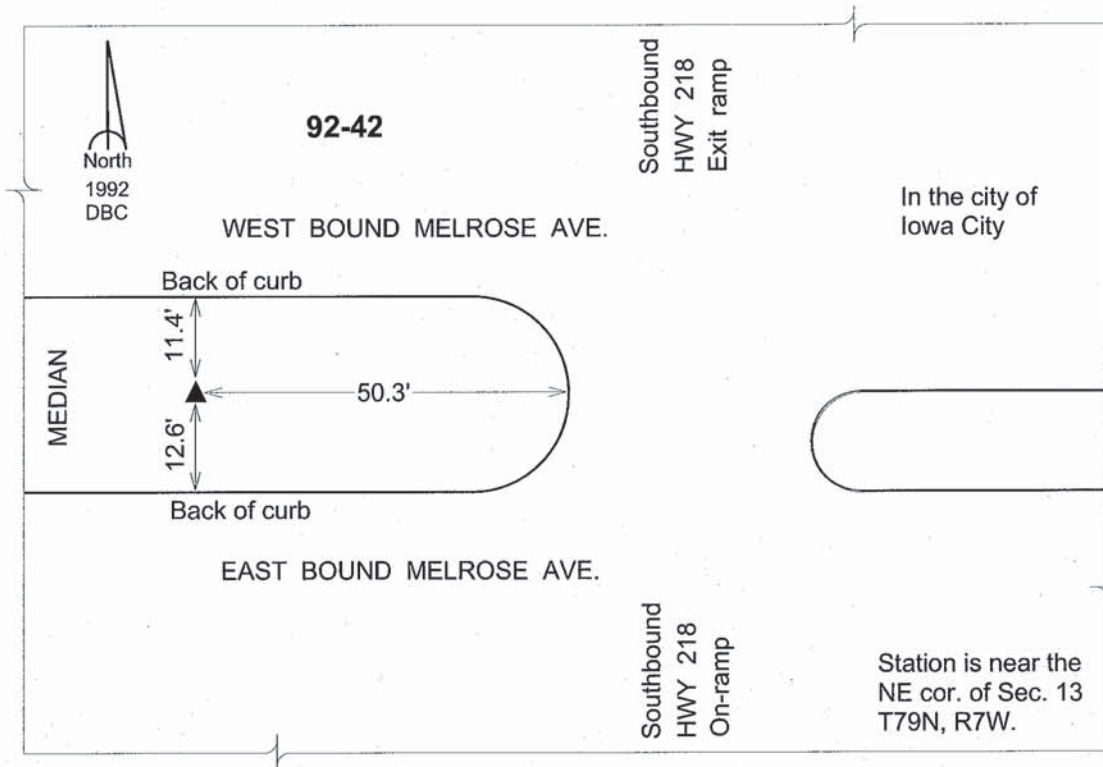

This document was prepared by DCI and GBC for use by Johnson County, Iowa.