

**Johnson County, Iowa**  
Iowa South Zone (1402)  
Horiz. Datum: NAD83(1996)  
Vert. Datum: NAVD 1988  
US Survey Feet  
**2006**

Point Name: **95**

**Designation:** NGS 2nd order vertical station "F 85" PID: MG0618

Northing: **662809.46sft** Easting: **2090746.60sft**

Orthometric Height: **735.89sft** Ellipsoid Height: **630.23sft** **Geoid03**

Latitude: **41°48'26.81166"N** Longitude: **91°50'53.35528"W**

Mapping Angle: **1°05'17"** Combination Scale Factor: **0.99997430**

**Monument Type:** A standard bench mark disk set in the top of a concrete monument.

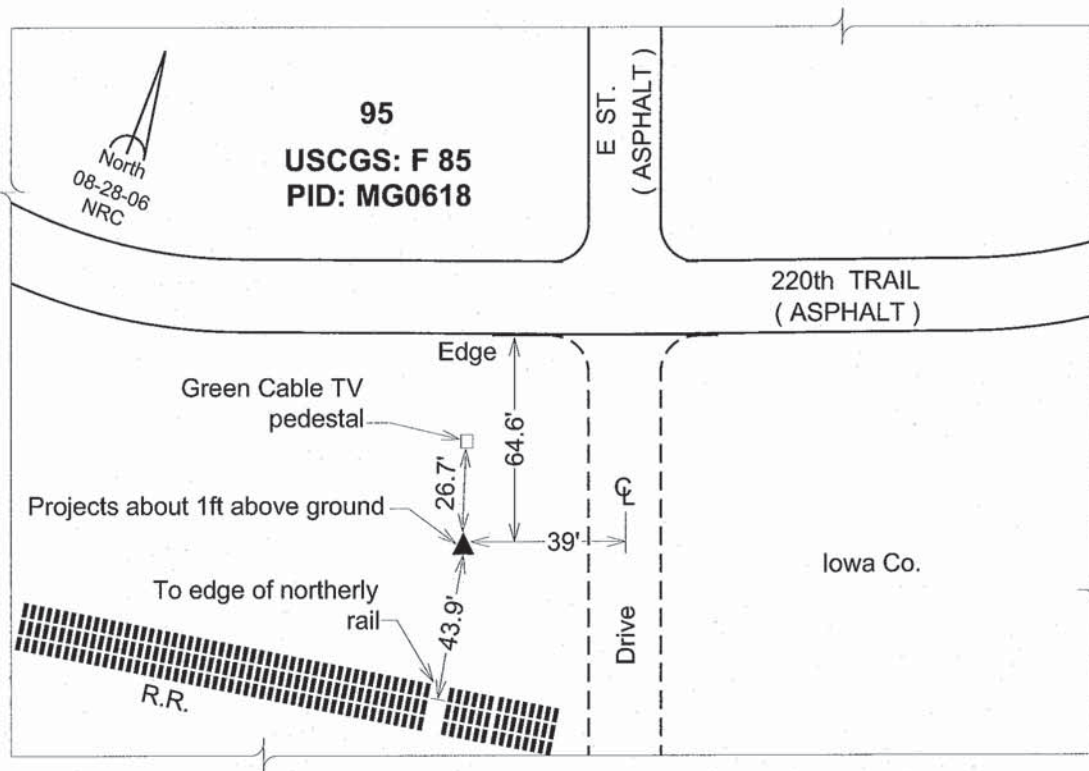

*This document was prepared by DCI and GBC for use by Johnson County, Iowa.*