

Johnson County, Iowa  
Iowa South Zone (1402)  
Horiz. Datum: NAD83(1996)  
Vert. Datum: NAVD 1988  
US Survey Feet  
2006

Point Name: 104

Designation: 96-104 City of Coralville GPS Control Point (Set by ASI in 1996)

Northing: 622764.33sft Easting: 2167547.24sft

Orthometric Height: 786.73sft Ellipsoid Height: 679.90sft Geoid03

Latitude: 41°41'35.65173"N

Longitude: 91°34'11.23802"W

Mapping Angle: 1°16'17"

Combination Scale Factor: 0.99995280

Monument Type: 5/8" dia. driven aluminum rod with a 2-1/2" dia. aluminum cap and permanent magnet encased in a 6" dia. PVC pipe with an aluminum access cover.

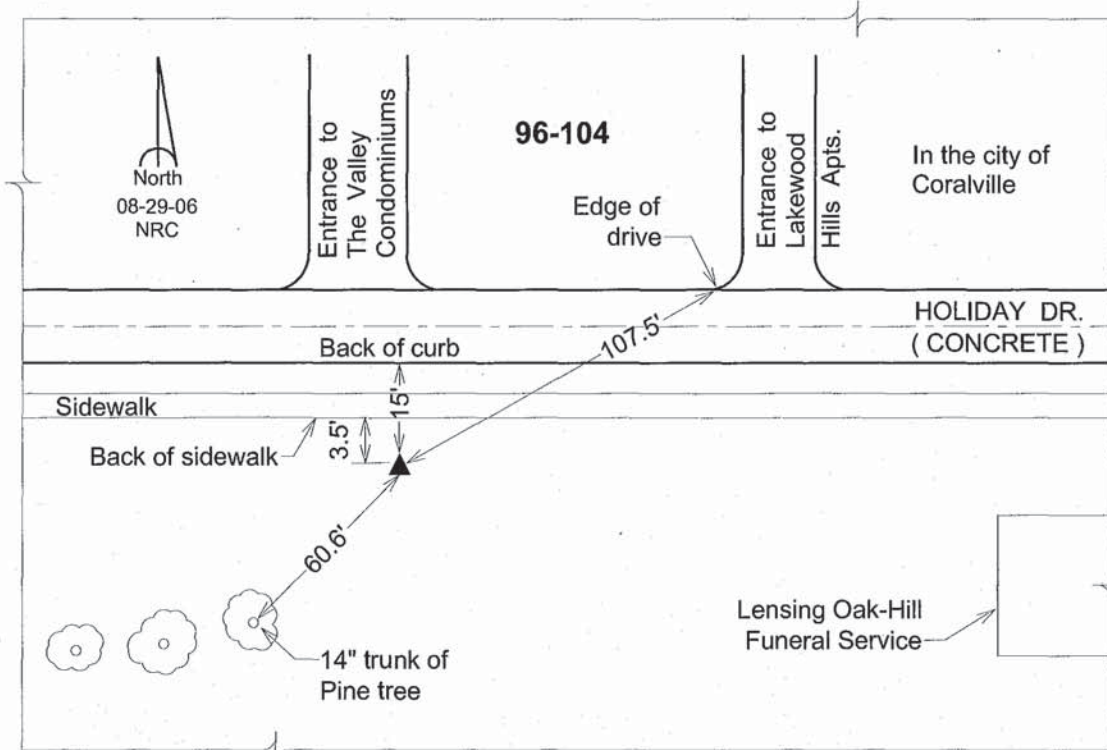

This document was prepared by DCI and GBC for use by Johnson County, Iowa.