

Johnson County, Iowa
Iowa South Zone (1402)
Horiz. Datum: NAD83(1996)
Vert. Datum: NAVD 1988
US Survey Feet
2006

Point Name: **223**

Designation: 2006-223 City of North Liberty GPS Control (Set by DCI in 2006)

Northing: **645727.16sft** Easting: **2151136.53sft**

Orthometric Height: **764.15sft** Ellipsoid Height: **657.58sft** **Geoid03**

Latitude: **41°45'26.00140"N**

Longitude: **91°37'40.98676"W**

Mapping Angle: **1°13'59"**

Combination Scale Factor: **0.99996409**

Monument Type: Berntsen Top Security Rod Monument with a 2-1/2" dia. domed survey cap and permanent magnet encased in a 6" dia. PVC pipe with a NGS style aluminum access cover.

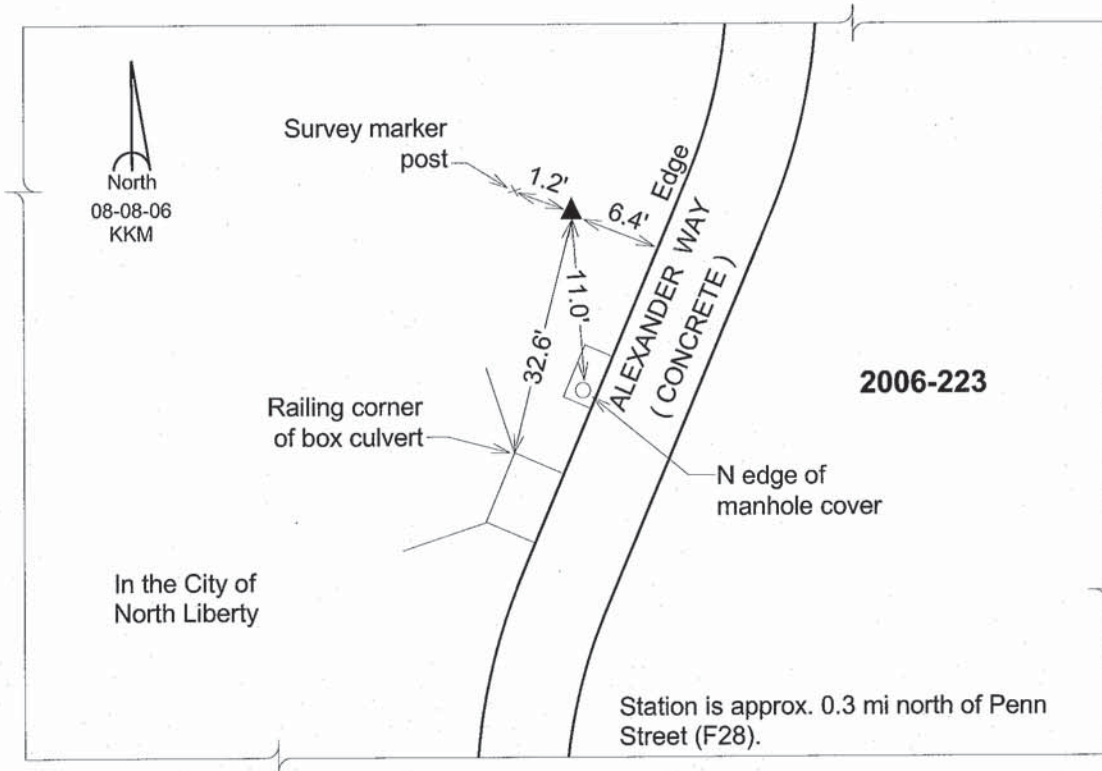

This document was prepared by DCI and GBC for use by Johnson County, Iowa.