

Johnson County, Iowa
 Iowa South Zone (1402)
 Horiz. Datum: NAD83(1996)
 Vert. Datum: NAVD 1988
 US Survey Feet
2006

Point Name: **228**

Designation: 2006-228 City of Coralville GPS Control Pt (Set by DCI in 2006)

Northing: **627029.51sft** Easting: **2162533.79sft**

Orthometric Height: **805.35sft** Ellipsoid Height: **698.58sft** **Geoid03**

Latitude: **41°42'18.87343"N**

Longitude: **91°35'16.06937"W**

Mapping Angle: **1°15'34"**

Combination Scale Factor: **0.99995373**

Monument Type: Berntsen Top Security Rod Monument with a 2-1/2" dia. domed survey cap and permanent magnet encased in a 6" dia. PVC pipe with a NGS style aluminum access cover.

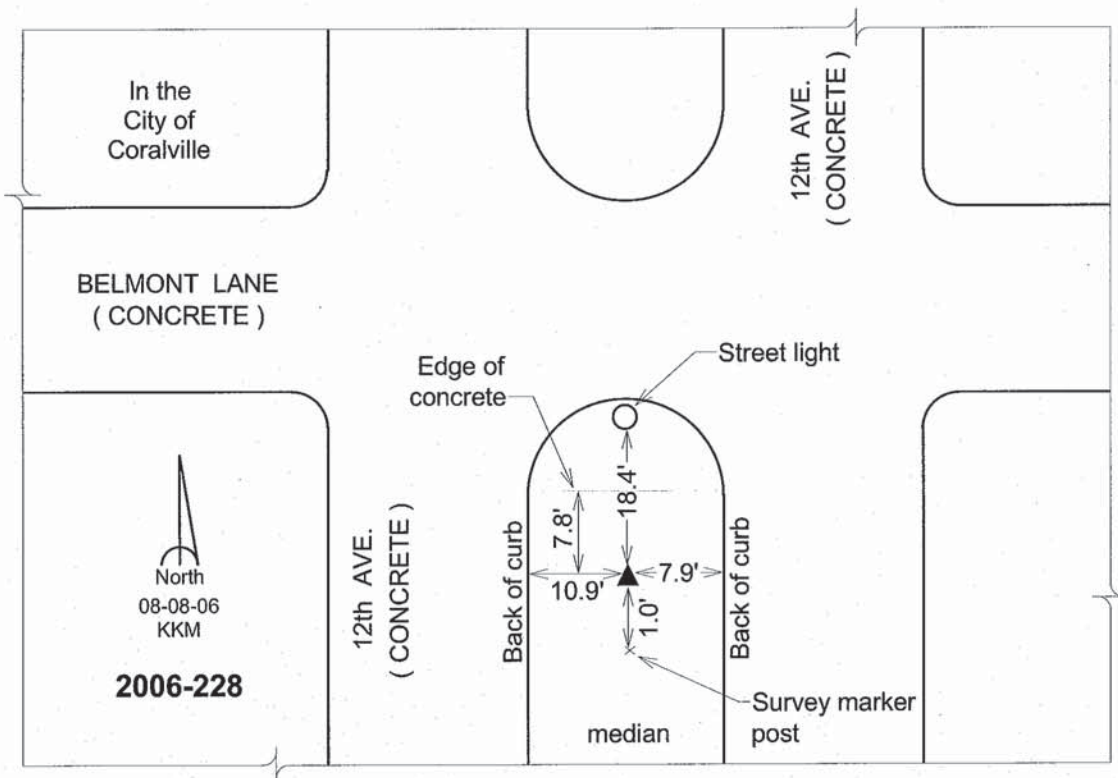

This document was prepared by DCI and GBC for use by Johnson County, Iowa.