

Johnson County, Iowa
Iowa South Zone (1402)
Horiz. Datum: **NAD83(NA2011)**
Vert. Datum: NAVD 1988
US Survey Feet
2013

Point Name: **106**

Designation: 96-106 City of Coralville GPS Control Point (Set by ASI in 1996)

Northing: **621282.77sft** Easting: **2162429.50sft**

Orthometric Height: **761.95sft** Ellipsoid Height: **655.03sft** **Geoid12A**

Latitude: **N41°41'22.13454"** Longitude: **W91°35'19.10862"**

Mapping Angle: **1°15'32"** Combination Scale Factor: **0.999953429**

Monument Type: 5/8" dia. driven aluminum rod with a 2-1/2" dia. aluminum cap and permanent magnet encased in a 6" dia. PVC pipe with an aluminum access cover.

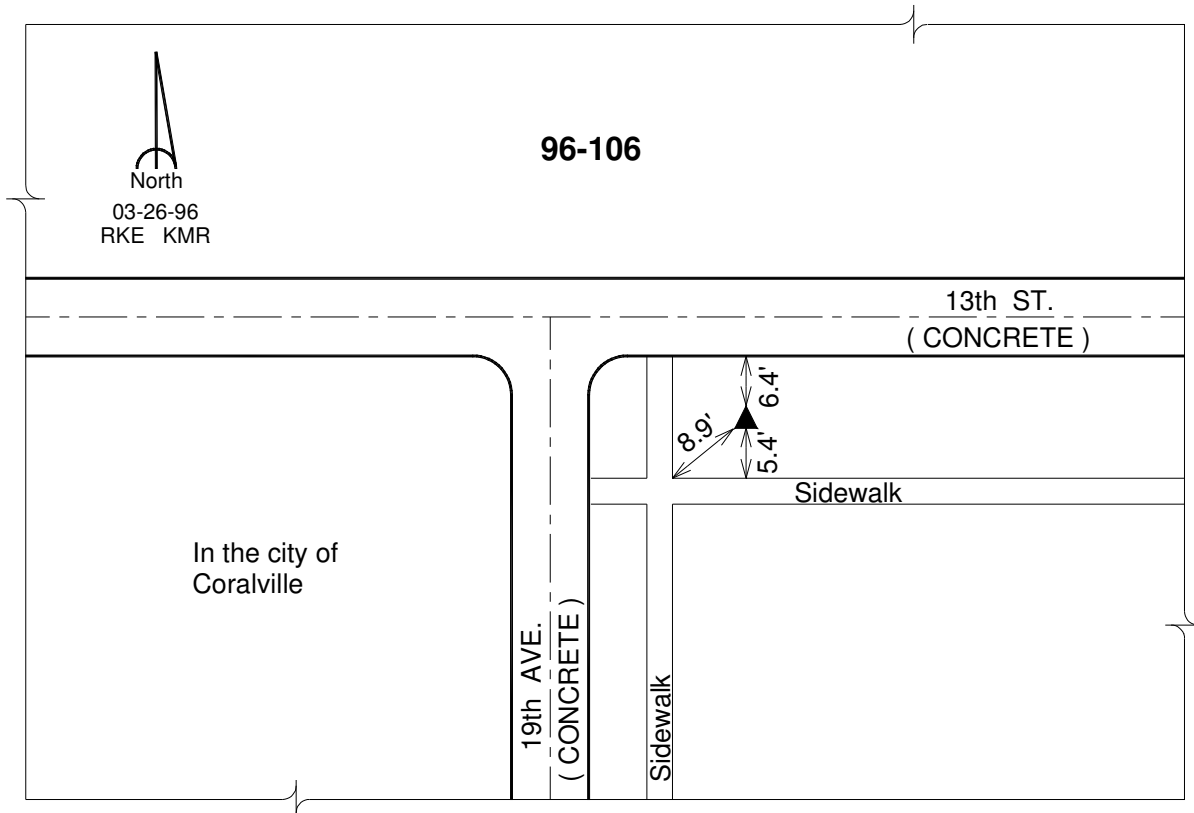

This document was prepared by DCI on 03-05-2013 for use by Johnson County, Iowa.