

Johnson County, Iowa
Iowa South Zone (1402)
Horiz. Datum: **NAD83(NA2011)**
Vert. Datum: NAVD 1988
US Survey Feet
2013

Point Name: **226**

Designation: 2006-226 City of Coralville GPS Control Pt (Set by DCI in 2006)

Northing: **633423.26sft** Easting: **2160450.51sft**

Orthometric Height: **759.71sft** Ellipsoid Height: **652.85sft** **Geoid12A**

Latitude: **N41°43'22.47694"** Longitude: **W91°35'41.68183"**

Mapping Angle: **1°15'18"** Combination Scale Factor: **0.999958679**

Monument Type: Berntsen Top Security Rod Monument with a 2-1/2" dia. domed survey cap and permanent magnet encased in a 6" dia. PVC pipe with a NGS style aluminum access cover.

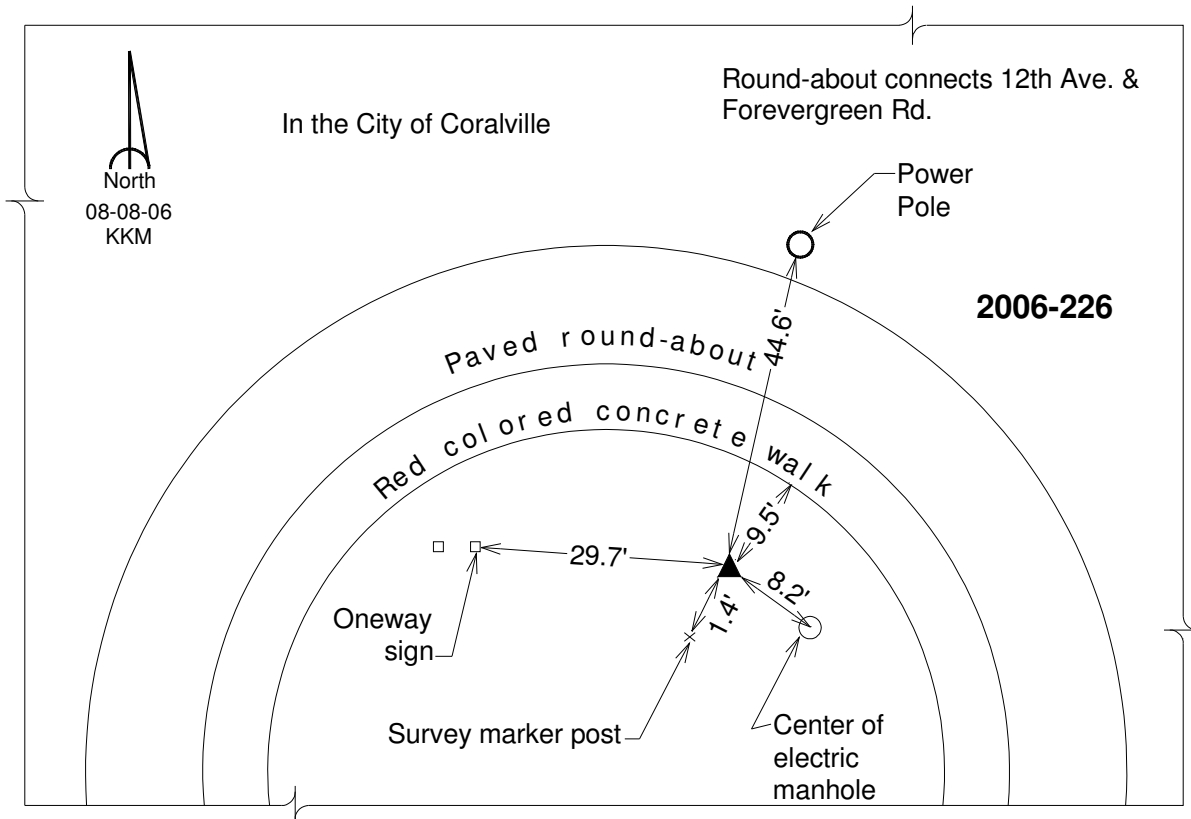

This document was prepared by DCI on 03-05-2013 for use by Johnson County, Iowa.