

Kossuth County, Iowa
Iowa North Zone (1401)
Horiz. Datum: NAD83(1996)
Vert. Datum: NAVD 1988
US Survey Feet
2005

Point Name: **428**

Designation: PA-0428 Palo Alto Co GPS Control Point (Set by Palo Alto Co. in 2004)

Northing: **3906166.36**sft Easting: **4669502.09**sft

Orthometric Height: **1266.61**sft Ellipsoid Height: **1173.00**sft **Geoid03**

Latitude: **43°12'43.34843"N** Longitude: **94°26'39.54251"W**

Mapping Angle: **-0°38'24"** Combination Scale Factor: **0.999934510**

Monument Type: Berntsen Top Security Rod Monument with a 3-1/4" dia. domed survey cap and permanent magnet encased in a 5"dia. PVC pipe with a NGS style aluminum access cover.

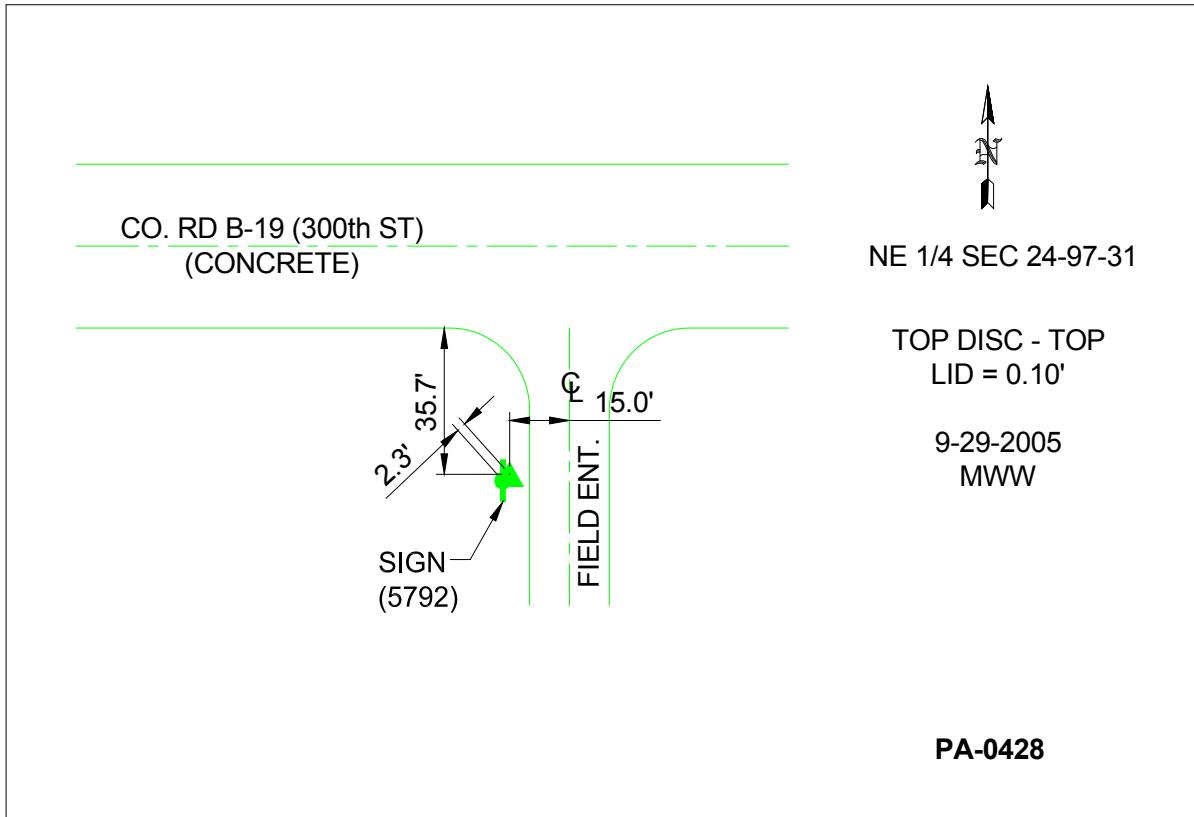

This document was prepared by DCI and GBC for use by Kossuth County, Iowa.